

217891001

CE

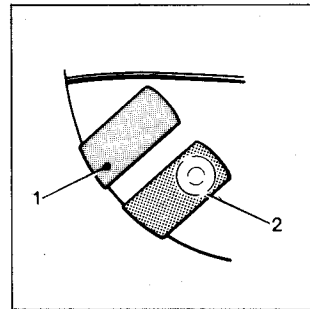
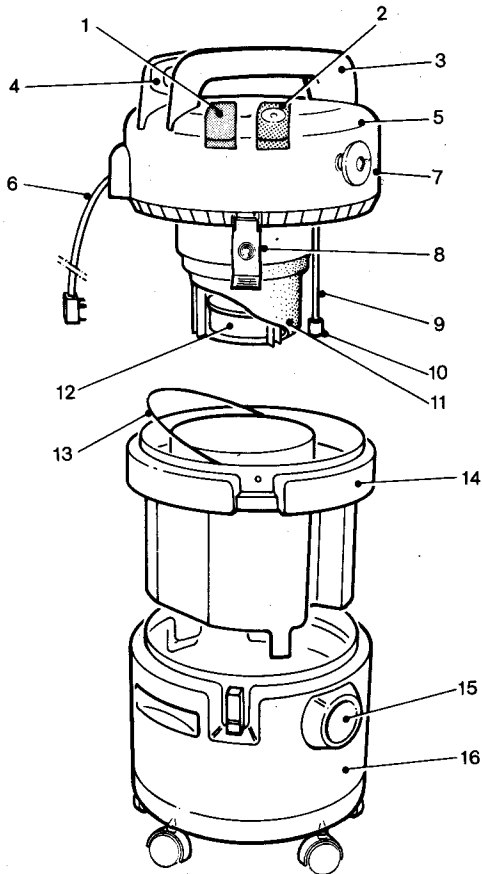

Fig. 1

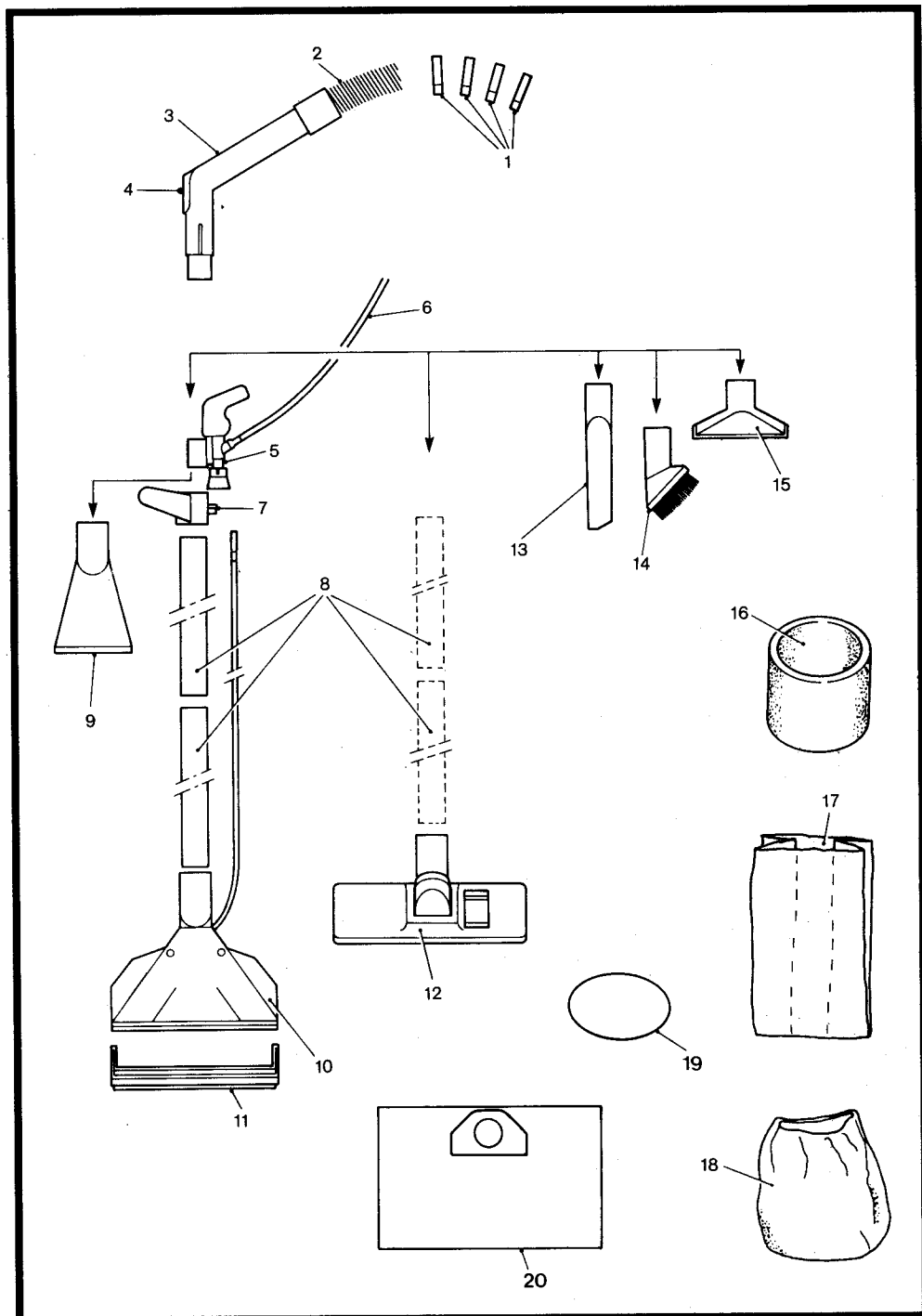

Fig. 2

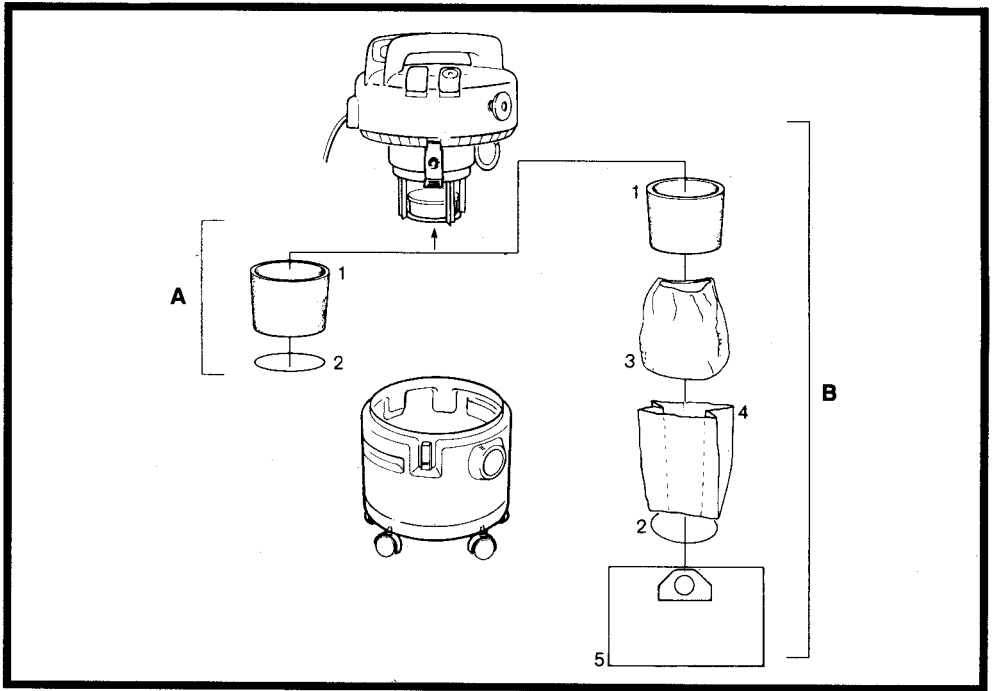

Fig. 3

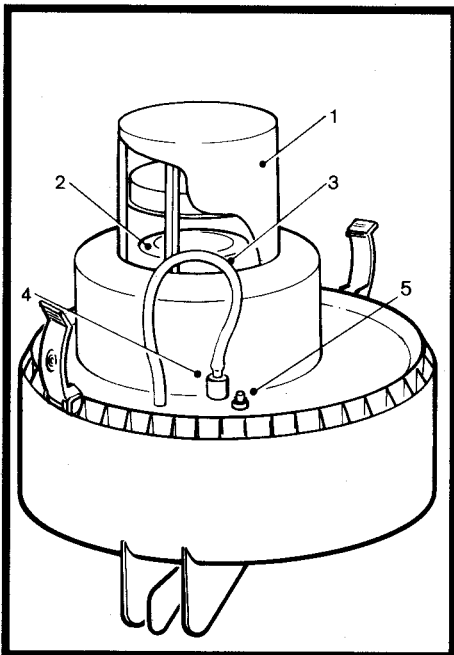

Fig. 4

| | | |
|-------|---|---|
| START | | |
| 1 | 2 | 3 |
| 4 | 5 | 6 |
| 7 | 8 | 9 |

Fig. 5

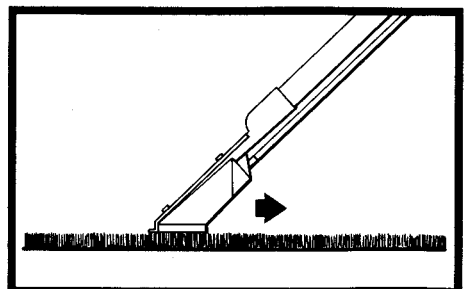

Fig. 6

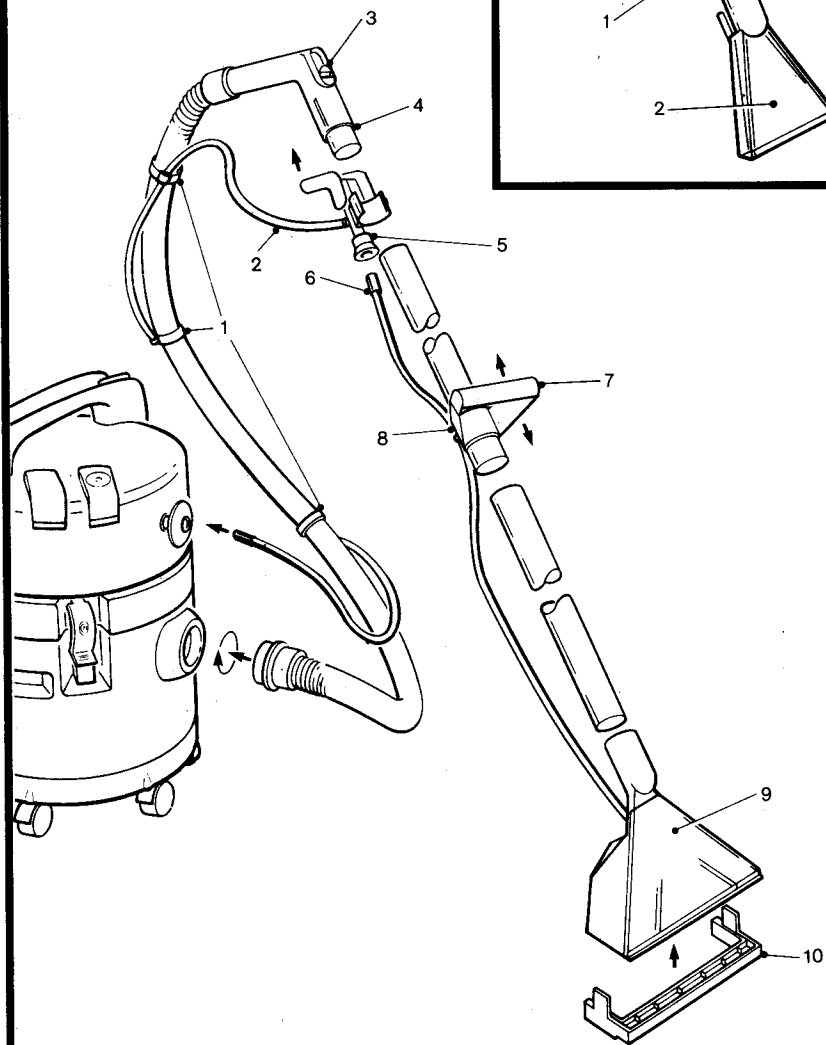

Fig. 7

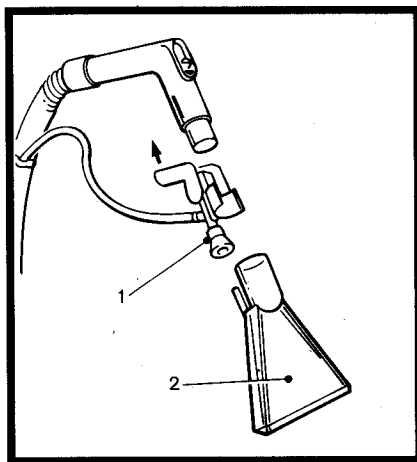

Fig. 8

This Wet, Dry and Shampoo Cleaner is simple to use but it is important that you carefully read these instructions before use.

IMPORTANT USER INFORMATION

It is most important that this instructions book should be retained with the appliance for future reference. Should the appliance be sold or transferred to another owner, or should you move house and leave the appliance, always ensure that the book is supplied with the appliance in order that the new owner can be acquainted with the functionings of the appliance and the relevant warnings.

- These warnings are provided in the interest of safety. You must read them carefully before installing or using the appliance.
- This appliance is designed to be operated by adults. Children should not be allowed to tamper with the controls or play with the product.
- It is dangerous to alter the specifications or modify the product in any way.
- Do not use the appliance in the presence of flammable gases.
- Never leave the appliance running unattended.
- Remove the plug from the wall socket before attempting any form of user maintenance specified in the user instruction booklet.
- Do not carry or drag your vacuum cleaner by the mains supply cable.
- Do not tug at the mains supply cable to remove the plug from the wall socket.
- Keep the mains supply cable away from heat, oil, sharp edges and rough surfaces.
- Always ensure that the cable is not damaged in any way.
- Never pick up hot cinders of lighted cigarette ends.
- Extreme care is required when cleaning stair carpets with your appliance. Ensure that your cleaner is in a stable position at the bottom of the stairs, and take care not to stretch the hose beyond its actual length. Always ensure when using your cleaner on the stair treads that you keep one hand firmly on the appliance.
- Dust bags and filters should be changed at regular intervals as stated in your instruction booklet.
- Do not use the appliance for wet vacuuming with the foam filter removed.
- Do not use the appliance for dry vacuuming with the foam and paper filters removed.
- When fitting and changing the accessories always follow the instructions in the user instruction booklet.
- Under no circumstances should you attempt to repair the appliance yourself. Repairs undertaken by unauthorised or inexperienced persons may cause injury and/or serious malfunctioning.
- This appliance should be serviced by authorised personnel and only genuine spare parts should be used.
- Always remove liquids from the container after use.
- Some proprietary carpet conditioning powders contain substances which if left in the vacuum cleaner for extended periods may damage the plastic parts of the cleaner. Please check the manufactures instructions of these powders before use.
- Extreme care is required when carpet/upholstery shampooing near

wall sockets. Do not spray towards a socket or any electrical appliance.

- When using the machine for wet pick-up ensure that the correct accessories are used as stated in your instruction book.

UNPACKING YOUR CLEANER

Unpack your cleaner and ensure that you have a complete set of accessories as shown below. Some desired level is obtained.

FIG. 1

1. On/Off switch
2. Shampoo pump lighted switch
3. Carrying handle
4. Mains lead storage
5. Power unit
6. Mains lead
7. Quick release shampoo solution tube connector
8. Security latch
9. Shampoo solution tube
10. Gauze filter
11. Foam filter
12. Floating valve
13. Carrying handle
14. Shampoo solution tank
15. Hose connector
16. Dust/water container

FIG. 2

1. Shampoo solution tube clips
2. Hose
3. Hand grip
4. Suction regulator
5. Trigger spray control
6. Shampoo solution tube
7. Adjustable support handle
8. Extension tubes

9. Upholstery nozzle
10. Shampoo nozzle
11. Hard floor adaptor
12. Carpet floor nozzle
13. Crevice tool
14. Dusting brush
15. All purpose nozzle
16. Foam filter
17. Paper filter
18. Cloth filter
19. Elastic band/Fastening ring
20. Dust bag

Carrying and Storage

The assembled cleaner should only be moved by the carrying handle on top of the power unit. Do not attempt to lift or drag the machine by the mains lead. The dust/water container is equipped with two side recesses to assist grip for carrying when emptying. The cleaner should be stored in a dry environment indoors.

Filters

Two filters are provided with the cleaner: (see fig. 3)

FIG. 3

A - Liquid use

1. Foam filter
2. Elastic band/Fastening ring

B - Dry use

1. Foam filter
2. Elastic band/Fastening ring
3. Cloth filter
4. Paper filter
5. Dust bag

(a) A foam filter is used for wet operations.

(b) Foam and paper filters, in conjunction with the dustbag, are used for dry suction only.

All filters are held in place by a plastic ring.

Securing Latches

- (a) To remove the power unit, unclip both securing latches and lift the power unit complete with mains lead of the dust/water container.
- (b) To refit the power unit, align both securing latches, ensuring that the quick release shampoo solution tube connector is lined-up with the hose connection on the dust/water container, firmly press the centre of both securing latches until they have locked in position.

OPERATING INSTRUCTIONS

Operating as a Dry Suction Cleaner

The solution tank is only used during shampooing and should be removed during dry suction and wet pick-up operations.

Ensure shampoo solution tube is secured in its stowage position (see Fig. 4).

FIG. 4

1. Foam outer filter
2. Foam inner filter
3. Shampoo solution tube
4. Gauze filter
5. Stowage pin

If the cleaner has been used to pick-up liquid, always ensure that the tank is dry before replacing the paper filter and dustbag for dry use.

The appliance may be operated with or without a dustbag, but it is recommended that one is used.

- (a) Ensure that the correct filters are fitted for dry operations (see Fig. 3).

- (b) Connect the extension tubes together and fit into the main hose handgrip.

- (c) Fit the carpet/floor nozzle, dusting brush or crevice nozzle, whichever is required.

NOTE:

The carpet/floor nozzle can be used in two modes, each of which are selected by a foot switch on the left hand side of the nozzle.

- (d) For hard floor cleaning press the foot switch backwards, locking the brushes in the extended position.

- (e) For carpet cleaning press the foot switch forward, locking the brushes in the retracted position.

Operating as a Wet Pick Up Cleaner

NOTE:

Ensure shampoo solution tube is secured its stowage position (see fig. 4).

- (a) Unclip the two securing latches and remove the power unit.
- (b) Remove the large elastic band or fastening ring securing the filters and lift off the paper filter and remove dust bag.
- (c) Retain foam filter with band. Items may be packed within the carton packaging.

Your new cleaner has been designed for use in and around the home, garage, workshop or garden. It comes supplied with a set of accessories suitable for a variety of cleaning tasks, including, dry vacuuming, liquid pick-up and carpet/hard floor cleaning. Upholstery may also be cleaned with the tools provided or using the special shampoo upholstery nozzle.

PLEASE NOTE

THE CLEANER IS SUPPLIED READY FOR DRY USE

GENERAL ASSEMBLY

Fit the threaded end of the hose into the hose connection on the cleaner body and turn in a clockwise direction to secure.

Extension Tubes and Cleaning

Tools

To connect extension tubes and tools simply push the appropriate items together until secure. To disconnect firmly twist the item and separate.

GENERAL POINTS ON USE OF CLEANER

Unwind the mains lead from the top of the cleaner, insert the mains plug into a suitable socket outlet and switch on. When you have finished cleaning, switch off mains supply, unplug and coil lead around the appropriate lugs within the handle.

Cleaner Controls

The following controls are provided:

- (a) The ON/OFF switch is situated on top of the power unit. To operate press firmly.
- (b) The shampoo pump lighted switch is situated next to the ON/OFF switch. This control is only used when shampooing and will be described in the carpet cleaning section.
- (c) The suction regulator is situated in the handgrip. When fully closed, suction power will be at maximum. To reduce suction, slide switch backwards.
- (d) Remove the shampoo solution tank.

- (e) Refit power unit ensuring that the blue quick release solution tube connector is aligned with the pick-up hose connection.
- (f) Fit the all purpose nozzle or crevice nozzle, whichever is required.

NOTES:

When doing a wet pick up, always remove the nozzle from the liquid before switching off the cleaner to ensure the hose is empty.

The carpet/floor nozzle or dusting brush must not be used for wet pick-up. After the cleaner has been used to pick-up liquid, always ensure that the tank is dry before replacing the paper filter and dustbag for dry use.

Operating as a Carpet Shampooer

- (a) Unclip and remove power unit.
- (b) Ensure foam filter only is fitted (see wet pick-up)
- (c) Following the instructions on the shampoo fill the solution tank with the correct proportions of cold water and shampoo up to a maximum capacity of 6 litres.

The shampoo tank may be filled whilst in the water container or removed with the carrying handle provided. Fitting of the shampoo tank should be carried out ensuring that the inlet recess is in line with the hose connection.

- (d) On the underside of the power unit, remove the solution tube from its stowage position (see Fig. 4)
- (e) Refit power unit ensuring that shampoo solution pipe drops into the small well at the bottom of the solution tank, clip in place using the two side fixings.
- (f) Fit trigger attachment to main hose hand grip (see Fig. 7).
- (g) Connect solution tube from trigger spray control to the blue quick release connector. Push firmly into

place until the insertion mark on the tube is aligned with the face of the connector.

- (h) Fit adjustable hand support to upper extension tube and lock at required height.
- (i) Fit shampoo head to extension tubes and pass solution tube length through adjustable support handle. Push solution tube into quick release connector on trigger spray control until the insertion mark on the tube is aligned with the face of the connector.
- (j) Plug into mains supply and activate cleaner with the green power on/off switch.
- (k) Press and hold down the shampoo pump lighted switch and operate trigger spray control while viewing shampoo head spraying nozzle.
- (l) When liquid sprays from the nozzle, release the shampoo pump switch and trigger.

FIG. 7

1. Clips
2. Solution tube
3. Suction regulator
4. Hose hand grip
5. Trigger spray control
6. Quick release connector
7. Adjustable support handle
8. Lock
9. Carpet shampoo nozzle
10. Hard floor adaptor

NOTE:

The spray is now controlled by the trigger action only.

- (m) To shampoo - place the shampoo head on the carpet, press the trigger and draw head slowly backwards. Release trigger (see Fig. 6).
- (n) Cover the area to be cleaned in sections as suggested below.

Working in proportional amounts towards a suitable exit, cleaned area. (see Fig. 5)

NOTE:

Do not over-wet carpet.

- (o) When shampooing of each section is complete, draw nozzle over area (without pressing trigger) a few times, until water pick up is minimal (as seen through clear cover on shampoo nozzle).
- (p) For cleaning hard floors (lino /tiles etc.) a clip on adaptor is provided for use with the shampoo nozzle. To use, simply clip on and proceed as above.
- (q) Disassembly is the reverse of assembly. To release the shampoo tubes exert a slight pressure to the face of the quick release connectors whilst gently withdrawing the shampoo tube.

NOTE:

It is important that all attachments are thoroughly cleaned by flushing with cold water after use.

Operating as an Upholstery Cleaner

Before cleaning, check with the manufacturer that the furniture is suitable for wet cleaning. Before use, check for colour fastness by using a cloth dampened with the cleaning fluid on an unobtrusive area of the fabric.

The procedure for upholstery cleaning is identical to shampooing. To fit the upholstery nozzle, proceed as follows (see Fig. 8).

FIG. 8

1. Quick release connector
 2. Upholstery nozzle
- 1) Line up the upholstery nozzle with the trigger control. Push firmly into position until the tube on the

upholstery nozzle is fully inserted into the quick release connector.

- 2) Insert the hose handgrip through the trigger control and into the upholstery nozzle.
- 3) To disassemble, push the quick release connector to release the tubing whilst gently withdrawing the upholstery nozzle.

Emptying Cleaner

The plug should always be removed from the mains supply before the cleaner is emptied.

If the cleaner has been used in the dry suction mode, the dust/water container must be emptied before using as a wet pick-up. Similarly if the cleaner has been used as a wet pick-up, the dust/water container must be emptied before using in the dry suction mode.

To empty the cleaner

- (a) Unclip the two securing latches and remove the power unit.
- (b) Lift out the solution tank by its carrying handle.
- (c) Empty the dust/water container.

Cleaning Filters

The filters will require regular cleaning as follows:

- (a) The foam filter should be washed in soapy water, rinsed and squeezed dry after each wet pick-up or shampooing operations.
- (b) The paper filter should be brushed while still fitted to the power unit after each emptying of the paper dustbag. It should be replaced when damaged or if cleaner suction is notably reduced.
- (c) The paper dustbag should be changed regularly. When replacing dustbags, use only genuine spares.

Loss of Suction

If your cleaner loses suction power check the following:

- (a) The hose and other accessories in-use are not blocked.
- (b) The filters are clean and the dustbag is not full.
- (c) For wet use: Check that the container is not overfull and that the foam filters are not blocked.

In the shampoo mode, if the trigger fails to operate check the following:

- (a) Shampoo tank is not empty and the tubing is properly connected.
- (b) Shampoo solution gauze filter and spray nozzle jet are not blocked.
- (c) Ensure that the correct procedure for starting the pump has been followed, for details refer to OPERATING INSTRUCTIONS paragraph (k) and (l).

Before storing the cleaner or reverting to dry use, the pump shampoo system must be internally cleaned.

First remove, clean and replace the shampoo solution tube gauze filter assembly, fitted to the end of the solution pick-up tube.

Put some clean water in the blue shampoo tank and operate the trigger spray control, to flush water through the system to the floor nozzle for approximately 1 minute.

On completion, replace the solution pick-up tube on its storage pin located under the power unit.

Any further servicing or maintenance should be carried out by authorized Service Staff.

IMPORTANT

Should you require service on your cleaner, please contact your nearest service office. Before requesting service, please check whether your problem is covered under important user information.

IMPORTANT - If the supply cord of this appliance is damaged, it must only be replaced by a qualified service engineer

Spares

New filter and paper dust bags, can be obtained from authorized dealers.

Please specify when ordering spares.

