

Nokia 303 User Guide

Contents**Safety****4****Get started****5**

Keys and parts	5
Write with the keyboard	5
Insert a SIM card and battery	6
Insert a memory card	8
Charge the battery	9
Attach a strap	10
Switch the phone on or off	10
Antenna locations	11

Basic use**11**

Access codes	11
Lock the keys and screen	12
Touch screen actions	12
Indicators	14
Copy contacts or pictures from your old phone	14
Change the volume of a call, song, or video	15

Calls**15**

Make a call	15
Call the last dialled number	15
View your missed calls	15
About internet calls	16
Make an internet call	16

Contacts**17**

Save a name and phone number	17
Use speed dial	17

Write text**18**

Text input features	18
Write using the keyboard	18
Predictive text input	19

Messaging**19**

Send a message	19
View a conversation	20
Messaging key	20
Listen to voice messages	20
Send an audio message	21

Personalise your phone**21**

About the home screen	21
Personalise the home screen	21
Personalise your phone tones	22

Time management**23**

Change the time and date	23
Set an alarm	23
Add an appointment	23

Connectivity**24**

Bluetooth	24
USB data cable	25
Connect to a WLAN	26

Music and audio**27**

FM radio	27
Media player	29
Media key	29

Pictures and videos**30**

Take a picture	30
Record a video	30
Send a picture or video	30

Web**31**

About the web browser	31
Browse the web	31
Fit a web page to your phone display	32
Add a bookmark	32
Clear your browsing history	33

Keep in touch with your online friends**33**

About Social	33
--------------	----

Mail and chat	33
About Mail	33
Send a mail	34
Read and reply to mail	34
About Chat	34
Chat with your friends	34
Nokia Maps	35
About Maps	35
Download maps	35
View your current location on the map	35
Find a place	36
Share your location or a place	36
Create a walking route	37
Nokia Services	37
Availability and costs of Nokia Services	37
Access Nokia Services	37
Find help	37
Support	37
Subscribe to the Tips and Offers service	38
Keep your phone up to date	38
Protect the environment	40
Save energy	40
Recycle	41
Product and safety information	41
Index	48

Safety

Read these simple guidelines. Not following them may be dangerous or illegal. For further information, read the complete user guide.

SWITCH OFF IN RESTRICTED AREAS



Switch the device off when mobile phone use is not allowed or when it may cause interference or danger, for example, in aircraft, in hospitals or near medical equipment, fuel, chemicals, or blasting areas. Obey all instructions in restricted areas.

ROAD SAFETY COMES FIRST



Obey all local laws. Always keep your hands free to operate the vehicle while driving. Your first consideration while driving should be road safety.

INTERFERENCE



All wireless devices may be susceptible to interference, which could affect performance.

QUALIFIED SERVICE



Only qualified personnel may install or repair this product.

KEEP YOUR DEVICE DRY



Your device is not water-resistant. Keep it dry.

PROTECT YOUR HEARING



Listen to a headset at a moderate level, and do not hold the device near your ear when the loudspeaker is in use.

Get started

Keys and parts

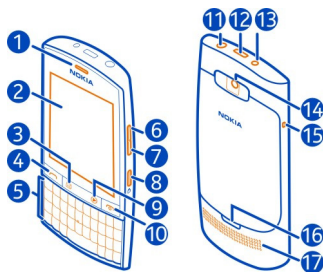

- 1 Earpiece
- 2 Touch screen
- 3 Messaging key
- 4 Call key
- 5 Keyboard
- 6 Volume up/Zoom in key
- 7 Volume down/Zoom out key
- 8 Key lock button
- 9 Media key
- 10 End/Power key
- 11 Nokia AV connector (3.5 mm)
- 12 Micro-USB connector
- 13 Charger connector
- 14 Camera lens. Before using the camera, remove the protective tape from the lens.
- 15 Wrist strap hole
- 16 Back cover release latch
- 17 Loudspeaker



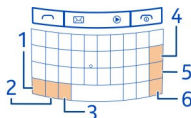

Write with the keyboard

Your phone has a full keyboard.



- 1 ↗ Function key. To insert special characters printed at the top of keys, press the function key, and then press the corresponding key. To enter several special

characters in a row, press the function key twice. To return to normal mode, press the function key.

- 2  Shift key. To switch between the upper and lower case modes, press the shift key twice. To enter a single upper case letter in lower case mode, or a single lower case letter in upper case mode, press the shift key, and then press the desired alphabet key.
- 3  Sym key. To insert special characters not shown on the keyboard, press the sym key, and select the desired character.
- 4  Backspace key. To delete a character, press the backspace key. To delete several characters, press and hold the backspace key.
- 5  Enter key. To move the cursor to the next row or text input field, press the enter key. Additional functions are based on the current context. For example, in the web address field of the web browser, the enter key acts as the Go icon.
- 6  Ctrl key

Insert a variation of a letter

You can insert, for example, letters with accents. To insert **á**, press and hold the sym key, and then press **A** repeatedly, until the desired letter is displayed. The order and availability of letters depends on the selected writing language.

Insert a SIM card and battery

 **Note:** Switch the device off and disconnect the charger and any other device before removing any covers. Avoid touching electronic components while changing any covers. Always store and use the device with any covers attached.

 **Important:** This device is designed to be used with a standard SIM card (see figure) only. Use of incompatible SIM cards may damage the card or the device, and may corrupt data stored on the card. Please consult your mobile operator for the use of a SIM card that has a mini-UICC cutout.



This phone is intended for use with a BP-3L battery. Always use original Nokia batteries.

The SIM card and its contacts can be easily damaged by scratches or bending, so be careful when handling, inserting, or removing the card.

- 1 Switch the phone off.
- 2 Pull the back cover release latch towards the bottom of the phone, and remove the cover.

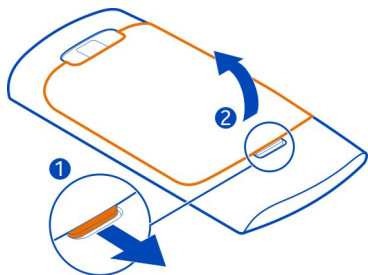

- 3 Remove the battery, if inserted.

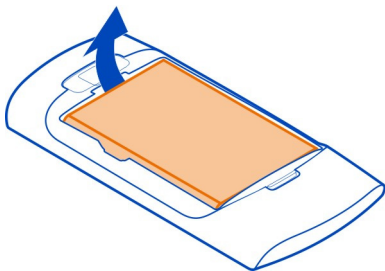

- 4 Lift the SIM card holder cover, make sure the contact area of the SIM card is facing down, and place the card in the holder.

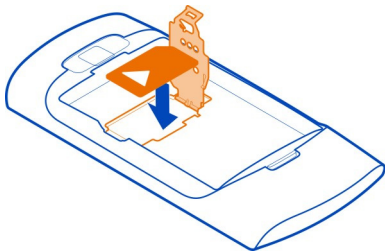

- 5 Lower the SIM card holder cover.
- 6 Line up the battery contacts, and insert the battery.



- 7 Direct the top locking catches toward their slots, and press down until the cover locks into place.

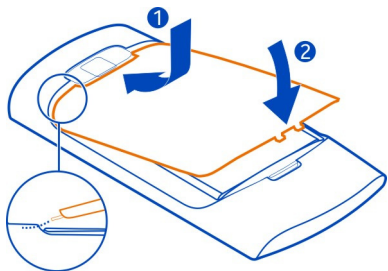

Remove the SIM card

- 1 Switch the phone off.
- 2 Remove the back cover.
- 3 Remove the battery, if inserted.
- 4 Lift the SIM card holder cover, and remove the SIM card.

Insert a memory card

Use only compatible memory cards approved by Nokia for use with this device. Incompatible cards may damage the card and the device and corrupt data stored on the card.

Your phone supports memory cards with a capacity of up to 32 GB.

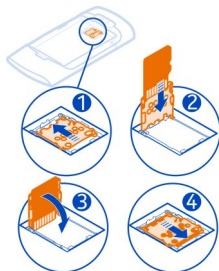

- 1 Switch the phone off, and remove the back cover and battery.
- 2 To release the memory card holder, slide the holder in the direction indicated by the arrow on the holder. Lift the memory card holder (1).
- 3 Make sure the contact area of the memory card would face down, and insert the card (2).
- 4 Lower the memory card holder (3).
- 5 To lock the memory card holder, slide the holder to its original position (4).

Remove the memory card

- 1 Switch the phone off.
- 2 Remove the back cover and battery.
- 3 To release the memory card holder, slide the holder in the direction indicated by the arrow on the holder. Open the memory card holder, and remove the memory card.

Charge the battery

Your battery has been partially charged at the factory, but you may need to recharge it before you can switch on your phone for the first time. If the phone indicates a low charge, do the following:

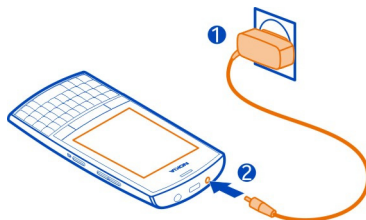

- 1 Connect the charger to a wall outlet.
- 2 Connect the charger to the phone.
- 3 When the phone indicates a full charge, disconnect the charger from the phone, then from the wall outlet.

You do not need to charge the battery for a specific length of time, and you can use the phone while it is charging.

If the battery is completely discharged, it may take several minutes before the charging indicator is displayed or before any calls can be made.

If the battery has not been used for a long time, to begin charging, you may need to connect the charger, then disconnect and reconnect it.

Attach a strap

Remove the back cover, thread the strap through the hole, and loop the strap around the wrist strap peg.

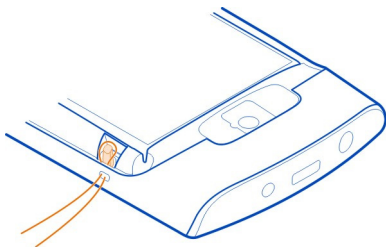

The strap may be available separately.

Switch the phone on or off

Press and hold the power key  until the phone vibrates.



You may be prompted to get the configuration settings from your network service provider. For more information on this network service, contact your network service provider.

Antenna locations

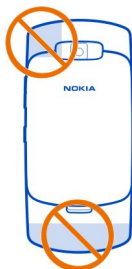

The antenna area is highlighted.

Avoid touching the antenna area while the antenna is in use. Contact with antennas affects the communication quality and may reduce battery life due to higher power level during operation.

Basic use

Access codes

<p>PIN or PIN2 code (4-8 digits)</p>	<p>These protect your SIM card against unauthorised use or are required to access some features.</p> <p>You can set your phone to ask for the PIN code when you switch it on.</p> <p>If not supplied with your SIM card or you forget the codes, contact your service provider.</p> <p>If you enter the code incorrectly three times in a row, you need to unblock the code with the PUK or PUK2 code.</p>
<p>PUK or PUK2 code (8 digits)</p>	<p>These are required to unblock a PIN or PIN2 code.</p> <p>If not supplied with your SIM card, contact your service provider.</p>

IMEI number (15 digits)	This is used to identify valid phones in the network. The number can also be used to block, for example, stolen phones. To view your IMEI number, dial *#06# .
Lock code (security code) (min. 5 digits)	This helps you protect your phone against unauthorised use. You can set your phone to ask for the lock code that you define. The default lock code is 12345. Keep the code secret and in a safe place, separate from your phone. If you forget the code and your phone is locked, your phone will require service. Additional charges may apply, and all the personal data in your phone may be deleted. For more information, contact a Nokia Care Point or your phone dealer.

Lock the keys and screen

To avoid accidentally making a call when your phone is in your pocket or bag, lock the keys and screen of your phone.

Press the key lock button.

Unlock the keys and screen

Press the key lock button, and select **Unlock**.

Touch screen actions

To interact with the touch screen user interface, tap or tap and hold the touch screen.

Open an application or other screen element

Tap the application or element.

Access item-specific options

Tap and hold the item. A pop-up menu with available options opens.

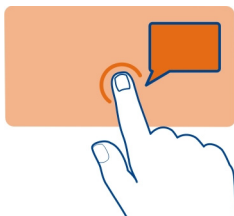

Scroll in a list or menu

Place your finger on the screen, slide it quickly up or down the screen, and then lift your finger. The content of the screen scrolls with the speed and direction it had at the moment of release. To select an item from a scrolling list and to stop the movement, tap the item.

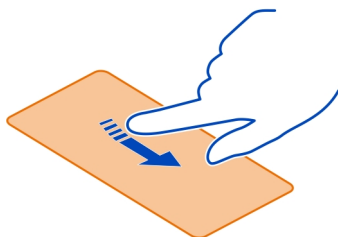





















Swipe

Place a finger on the screen, and steadily slide your finger in the desired direction.

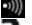

For example, when you are viewing a picture, to view the next picture, swipe left. To quickly browse through your pictures, swipe the screen quickly, and then scroll left or right through the thumbnails.

Indicators

	You have unread messages.
	You have unsent, cancelled, or failed messages.
	The keypad is locked.
	The phone does not ring for incoming calls or text messages.
	An alarm is set.
 or 	The phone is registered to the GPRS or EGPRS network.
 or 	A GPRS or EGPRS connection is open.
 or 	The GPRS or EGPRS connection is suspended (on hold).
	The phone is registered to a 3G (UMTS) network.
 or 	The phone is registered to a 3.5G (HSDPA) network.
	Bluetooth is activated.
	WLAN is activated.
	If you have two phone lines, the second line is in use.
	All incoming calls are diverted to another number.
	The currently active profile is timed.
	A headset is connected to the phone.
	The phone is connected to another device, using a USB data cable.

Copy contacts or pictures from your old phone

Want to copy your content from your previous compatible Nokia phone and start using your new phone quickly? You can copy, for example, contacts, calendar entries, and pictures to your new phone, free of charge.



- 1 Activate Bluetooth in both phones.

- Select **Menu > Settings > Connectivity > Bluetooth and On.**
- 2 Select **Menu > Settings > Sync & backup.**
 - 3 Select **Phone switch > Copy to this.**
 - 4 Select the content to copy and **Done.**
 - 5 Select your previous phone from the list.
 - 6 If the other phone requires a passcode, enter the passcode. The passcode, which you can define yourself, must be entered in both phones. The passcode in some phones is fixed. For details, see the user guide of the other phone.
The passcode is valid only for the current connection.
 - 7 If prompted, allow connection and copying requests.

Change the volume of a call, song, or video

Use the volume keys.

The built-in loudspeaker allows you to speak and listen from a short distance without having to hold the phone to your ear.

Activate the loudspeaker during a call

Select **Loudsp..**

Calls

Make a call

- 1 On the home screen, enter the phone number.
To delete a number, select **Clear.**
To enter the + character, used for international calls, press **+**.
- 2 To make the call, press the call key.
- 3 To end the call, press the end key.

Tip: To use the virtual keypad to enter the phone number, press the call key, and select **Dialler.**

Call the last dialled number

Trying to call someone, but they are not answering? It is easy to call them again.

- 1 On the home screen, press the call key.
- 2 Go to the number, and press the call key.

View your missed calls

Want to see who made the call you missed?

On the home screen, select **View**. The caller's name is displayed, if stored in the contacts list.

Missed and received calls are logged only if supported by the network, and the phone is switched on and within the network service area.

Call back the contact or number

Go to the contact or number, and press the call key.

View the missed calls later

Select **Menu > Contacts > Log and Missed calls**.

About internet calls

You can make and receive calls over the internet (network service). Internet call services may support calls between computers, between mobile phones, and between a Voice over Internet Protocol (VoIP) device and a traditional telephone.

Some internet call service providers allow free internet calls. For availability and connectivity costs, contact your internet call service provider.

The use of VoIP or other services may be restricted in some countries. For more information, contact your phone retailer, service provider, or local authorities.

To make or receive an internet call, you must be in the service area of a WLAN or 3G network, and be signed in to an internet call service.

When using the 3G network for making internet calls, check that your service provider supports internet calls in the 3G network. Flat-rate data plans are recommended to save costs.

Tip: If you do not have a flat-rate data plan from your service provider, to save data costs in your phone bill when making internet calls, use a WLAN.

Make an internet call

When you are signed into an internet call service, you can make internet calls.

The Net phone wizard helps you set up your account. Have your account information from your internet call service provider available before you start the wizard.

Set up your internet telephone account

- 1 Make sure a valid SIM card is inserted, and that your phone is connected to a WLAN or 3G network.
- 2 Select **Menu > Settings and Connectivity > Internet telephone**.
- 3 Select **Connect**, then follow the instructions shown on the phone.

When the wizard has finished, your account is displayed in the accounts list.

If the internet telephone settings do not work, contact your service provider.

Call a contact

- 1 Select **Menu** > **Contacts** and **Names**.
- 2 Select the contact and **Internet call**.

Call a phone number

Type in the phone number, then select **Options** > **Internet call**.

For emergency calls, only the cellular network is used.

Contacts

Save a name and phone number

Select **Menu** > **Contacts**.

Select **Add new**, and enter the number and name.

Add or edit the details of a contact

- 1 Select **Names** and a contact.
- 2 Select **Options** > **Add detail**.

Tip: To add a ringtone or picture for a contact, select the contact and **Options** > **Add detail** > **Multimedia**.

Use speed dial

You can quickly call your friends and family when you assign your most-used phone numbers to the number keys of your phone.

Select **Menu** > **Contacts** > **Speed dials**.

Assign a phone number to a number key

- 1 Select a number key. 1 is reserved for the voice mailbox.
- 2 Enter a number or search for a contact.

Remove or change a phone number assigned to a number key

Select and hold the number key, and from the pop-up menu, select **Delete** or **Change**.

Make a call

On the home screen, press and hold a number key.

Deactivate speed dialling

Select **Menu > Settings and Call > Speed dialling > Off**.

Write text

Text input features

Your phone has many features that help you easily and efficiently write in the text editor. One way to open the text editor is to select **Menu > Messaging and Create message**.

Write using the keyboard

Your phone has a full keyboard.

Set the writing language

Select **Options > Writing language** and the desired language. To change the writing language, you can also press the function key, and then press the ctrl key.

Switch between number and letter mode

Press the function key repeatedly, until the symbol for the desired input method is displayed.

Lock number mode

Press the function key twice. To return to normal mode, press the function key.

Switch between the character cases

Press the shift key.



Insert a number or character printed at the top right corner of a key

Press and hold the corresponding key.

Delete a character

Select **Clear**. You can also press the backspace key .

Insert a special character or symbol

Press the sym key, and select the desired symbol. To view more symbols, select  or .

Insert a new line

Press the enter key.

Insert a space

Press the space key.

Copy or cut text

Press and hold the shift key, and scroll to highlight a word, phrase, or section of text. Press and hold the ctrl key, and then press **C** (copy) or **X** (cut).

Paste text

Go to the desired location, press and hold the ctrl key, and then press **V**.

Predictive text input

Predictive text input is based on a built-in dictionary. Not all languages are supported.

Activate or deactivate predictive text input

Select **Options** > **Prediction sett.** > **On** or **Off**.

Switch between predictive and traditional text input

Press and hold the ctrl key, and then press the space key.

You can also select and hold **Options**.

Write text with predictive text input

- 1 Start writing a word, using the character keys. Your phone suggests possible words.
- 2 To confirm a word, press the space key.
If the word is not correct, scroll through the list of suggested words, and select the desired word.
- 3 Start writing the next word.

Messaging**Send a message**

Keep in touch with your family and friends with text and multimedia messages. You can attach your pictures, videos, and business cards to your message.

Select **Menu** > **Messaging**.

- 1 Select **Create message**.
- 2 To add an attachment, select **Options** > **Insert object**.
- 3 Write your message, and select **Continue**.
- 4 To enter a phone number or mail address manually, select **Number or mail**. Enter a phone number, or select **Mail**, and enter a mail address.
- 5 Select **Send**.

Tip: To insert a special character or smiley, select **Options > Insert symbol**.

Sending a message with an attachment may be more expensive than sending a normal text message. For more information, contact your service provider.

You can send text messages that are longer than the character limit for a single message. Longer messages are sent as two or more messages. Your service provider may charge accordingly.

Characters with accents, other marks, or some language options, take more space, limiting the number of characters that can be sent in a single message.

If the item you insert in a multimedia message is too large for the network, the device may automatically reduce the size.

Only compatible devices can receive and display multimedia messages. Messages may look different in different devices.

View a conversation

You can see the messages you have sent to and received from a particular contact from a single view, and continue the conversation from that view.

Select **Menu > Messaging**.

Read a message in a conversation

Select **Conversations**, a conversation, and a message.

Switch to the traditional Inbox view

Select **Options > Inbox view**.

Messaging key

To write a message or check your message inbox, press the messaging key .

Listen to voice messages

When you can't answer, you can divert calls to your voice mailbox and listen to your messages later.



You may need a voice mailbox subscription. For more information on this network service, contact your service provider.

- 1 Select **Menu > Messaging > Voice messages > Voice call messages and Voice mailbox no..**
- 2 Enter your voice mailbox number, and select **OK**.
- 3 To call your voice mailbox, on the home screen, press and hold **1**.

Send an audio message

Don't have time to write a text message? Record and send an audio message instead.

Select **Menu** > **Messaging**.

- 1 Select **Other messages** > **Audio message**.
- 2 To record your message, select .
- 3 To stop recording, select .
- 4 Select **Continue** and a contact.

Personalise your phone

About the home screen

On the home screen, you can:

- See notifications of missed calls and received messages
- Open your favourite applications
- Add shortcuts for different features, such as taking a picture or browsing the web
- View your favourite contacts, and quickly call, text, or send mail to them
- Access your favourite social networking services

Personalise the home screen

Want to see your favourite landscape or pictures of your family in the background of the home screen? You can change this wallpaper, and rearrange items on the home screen, to personalise it to your liking.

Change the wallpaper

- 1 Select **Menu** > **Settings and Display** > **Wallpaper**.
- 2 Select a folder and a picture.

You can also take a picture with your phone camera, and use that picture.

Tip: Download more wallpapers from Nokia Store. For more information, go to www.nokia.com/support.

Add an application or shortcut

- 1 Tap and hold the home screen, and from the pop-up menu, select **Personalise view**.
- 2 Select the bar, an item from the list, and **Done**.

Change a shortcut

- 1 Tap and hold the shortcut you want to change, and from the pop-up menu, select **Change shortcut**.

- 2 Select an item from the list.

Tip: To increase the font size in the Messaging and Contacts applications, or in the main menu, select **Menu > Settings and Display > Font size**.

Personalise your phone tones

You can personalise the ringtones and key and warning tones for each profile.

Select **Menu > Settings and Tones**.



Change the ringtone

Select **Ringtone**;, then select a ringtone from Gallery or from your downloaded tones.

Tip: Download more ringtones from Nokia Store. To learn more about Nokia Store, go to www.nokia.com/support.

After selecting a ringtone, you can mark a section of the ringtone, and set the section as your ringtone. The original ringtone or sound clip is not copied or modified. Preset ringtones cannot be modified, and not all formats of ringtones are supported.





Mark the section to use

- 1 Select a ringtone. When prompted, select **Yes**.
- 2 Drag the start marker  to the start point.
- 3 Drag the end marker  to the end point.

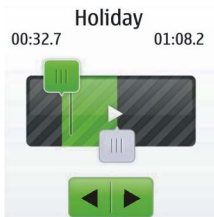
When a marker is moved to a new point, the selection plays.

- 4 To manually play the selection, select **Play**.
- 5 Select **Done**.



Tip: To fine-tune the start and end points of the selection, select  or , and select and hold  or .

Change the volume of the keypad tones

Select **Keypad tones**;, and drag the volume bar.

Time management

Change the time and date

Select **Menu** > **Settings** and **Date and time**.

Change the time zone when travelling

- 1 Select **Date & time settings** > **Time zone**..
- 2 Select the time zone of your location.
- 3 Select **Save**.

The time and date are set according to the time zone. This makes sure that your phone displays the correct sending time of received text or multimedia messages.

For example, GMT -5 denotes the time zone for New York (USA), 5 hours west of Greenwich, London (UK).

Set an alarm

You can use your phone as an alarm clock.

On the home screen, select the clock.

- 1 Set the alarm time.
- 2 Select  to set the alarm.
- 3 To set the alarm to sound, for example, at the same time every day, select **Settings** > **Alarm repeat** > **On** and the days.

Tip: To open the alarm clock, you can also select **Menu** > **Apps** > **Alarm clock**.

Add an appointment

Save your important appointments to your calendar as meeting entries.

Select **Menu** > **Calendar**.

- 1 Go to the desired date, and select **Options** > **Add new entry**.
- 2 Select **Meeting**, and fill in the fields.

Connectivity

Bluetooth

About Bluetooth connectivity

Select **Menu > Settings > Connectivity > Bluetooth**.

You can connect wirelessly to other compatible devices, such as phones, computers, headsets, and car kits.

You can use the connection to send items from your phone, copy files from your compatible PC, and print files with a compatible printer.

Since devices with Bluetooth wireless technology communicate using radio waves, they do not need to be in direct line-of-sight. However, they must be within 10 metres (33 feet) of each other, although the connection may be subject to interference from obstructions such as walls or from other electronic devices.

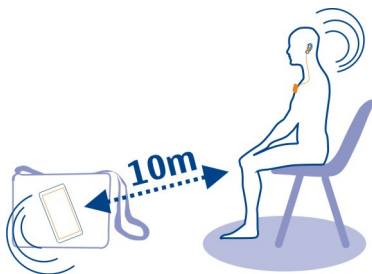

When your phone is locked, it is only possible to connect to a paired device that has been set to **Auto-connect**.

Tip: To quickly access the Bluetooth settings, on the home screen, press and hold the Bluetooth key  sym.

Send a picture or other content to another device using Bluetooth

Use Bluetooth to send pictures, videos, business cards, and other content created by you to your computer or a friend's compatible phone or device.

- 1 Select and hold the item to send, and from the pop-up menu, select **Send > Via Bluetooth**.
- 2 Select the device to connect to. If the desired device is not displayed, to search for it, select **Options > New search**. Bluetooth devices within range are displayed.

- 3 If the other device requires a passcode, enter the passcode. The passcode, which you can define yourself, must be entered in both devices. The passcode in some devices is fixed. For details, see the user guide of the device.
The passcode is valid only for the current connection.

The available options may vary.

USB data cable

Copy content between your phone and a computer

You can use a USB data cable to copy your pictures and other content between your phone and a compatible computer.

- 1 Use a USB data cable to connect your phone to a computer.
- 2 Select from the following modes:

Nokia Suite — Nokia Suite is installed on your computer.

Media transfer — Nokia Suite is not installed on your computer. If you want to connect your phone to a home entertainment system or printer, use this mode.

Mass storage — Nokia Suite is not installed on your computer. The phone is displayed as a portable device on your computer. Make sure a memory card is inserted. If you want to connect your phone to other devices, such as a home or car stereo, use this mode.

- 3 To copy the content, use the file manager of the computer.
To copy your contacts, music files, videos, or pictures, use Nokia Suite.

Copy a picture or other content between your phone and a USB memory stick

You can copy pictures from your phone to a compatible USB memory stick. Use this to create backups of pictures that you take when travelling.

- 1 Connect a compatible USB OTG adapter cable to the micro-USB connector of your phone.
- 2 Connect a memory stick to the USB OTG adapter cable.

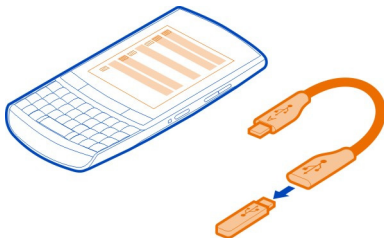

- 3 Select **Menu** > **Apps** > **Gallery**, and select and hold a file or folder.
- 4 Select if you want to copy or move the file or folder.
- 5 Select the target folder.

Connect to a WLAN

About WLAN connections

Select **Menu** > **Settings** > **Connectivity** > **WLAN**.

Connect to a wireless local area network (WLAN) and manage your WLAN connections.

Tip: To quickly access the WLAN settings, on the home screen, press and hold the WLAN key .

! Important: Use encryption to increase the security of your WLAN connection. Using encryption reduces the risk of others accessing your data.

Connect to a WLAN at home

To help save data costs, connect to your home WLAN when you are at home and want to browse the web on your phone.

Select **Menu** > **Settings** > **Connectivity** > **WLAN**.

Connect for the first time

- 1 To search for your home WLAN, select **Available WLANs**.
- 2 To connect, select your home WLAN.
- 3 If the WLAN is secured , enter the password.
- 4 If you save your home WLAN, you do not always have to search for it in future. Select and hold the WLAN, and from the pop-up menu, select **Save**.

 indicates a saved WLAN.

Connect to your saved home WLAN

- 1 Select **Saved WLANs**.
- 2 Select and hold your home WLAN, and from the pop-up menu, select **Connect**.

Disconnect from a WLAN

Select and hold the connected WLAN , and from the pop-up menu, select **Disconnect**.

Connect to a WLAN on the move

Connecting to a WLAN is a handy way of accessing the internet when not at home. Connect to public WLANs in public places, such as a library or internet café.

Select **Menu > Settings > Connectivity > WLAN**.

You need a password to connect to secured WLANs .

- 1 To search for available WLANs, select **Available WLANs**.
- 2 Select a WLAN.
- 3 If the WLAN is secured, enter the password.

Disconnect from a WLAN

Select and hold the connected WLAN , and from the pop-up menu, select **Disconnect**.

Connect to a hidden WLAN

Select **Menu > Settings > Connectivity > WLAN**.

You can connect to a hidden WLAN, if you know the name (SSID) and password.

- 1 To search for available WLANs, select **Available WLANs**.
- 2 Select **(Hidden network)**.
- 3 Enter the name (SSID) and the password.

Disconnect from a WLAN

Select and hold the connected WLAN , and from the pop-up menu, select **Disconnect**.

Music and audio

FM radio

About the FM radio

Select **Menu > Music > Radio**.

You can listen to FM radio stations using your phone - just connect a headset, and select a station.

To listen to the radio, you need to connect a compatible headset to the device. The headset acts as an antenna.

It is not possible to listen to the radio through a Bluetooth headset.



Listen to the radio

Connect a compatible headset to your phone. The headset acts as an antenna.

Select **Menu** > **Music** > **Radio**.

Change the volume

Use the volume keys.

Close the radio

Press the end key.

Set the radio to play in the background

Select **Options** > **Play in backgr..**

Close the radio when it is playing in the background

Press and hold the end key.

Find and save radio stations

Search for your favourite radio stations, and save them, so you can easily listen to them later.

Select **Menu** > **Music** > **Radio**.

Search for the next available station

Select and hold  or .

Save a station

Select **Options** > **Save station**.

Automatically search for radio stations

Select **Options** > **Search all stat..** For best results, search when outdoors or near a window.

Switch to a saved station

Select  or .

Rename a station

- 1 Select **Options** > **Stations**.
- 2 Select and hold the station, and from the pop-up menu, select **Rename**.

Automatically switch to a frequency with better reception

- 1 Select **Options** > **Settings** > **RDS** > **On**.
- 2 Select **Options** > **Settings** > **Auto-frequency** > **On**.

Tip: To access a station directly from the saved station list, press the number key that corresponds to the number of the station.

Media player

Play a song

Play music stored in the phone memory or on the memory card.

Select **Menu** > **Music** > **My music** and **All songs**.

- 1 Select a song.
- 2 To pause playing, select ; to resume, select .

Play a video

Play videos stored in the phone memory or on the memory card.

Select **Menu** > **Photos** > **My videos**.

- 1 Select a video.
- 2 To pause playback, select ; to resume, select .

Media key

To open either the media player or the radio, depending on which was last used, press the media key .

Pictures and videos

Take a picture

- 1 Select **Menu** > **Photos** > **Camera**.
- 2 To zoom in or out, use the volume keys.
- 3 Select .

The pictures are saved in **Menu** > **Photos** > **My photos**.



Close the camera

Select .

Record a video

Besides taking pictures with your phone, you can also capture your special moments as videos.

Select **Menu** > **Photos** > **Video camera**.

- 1 To switch from image mode to video mode, if necessary, select  > **Video c..**
- 2 To start recording, select .
- To zoom in or out, use the volume keys.
- 3 To stop the recording, select .

Videos are saved in Gallery.

Close the camera

Select .

Send a picture or video

Want to share your pictures and videos with friends and family? Send a multimedia message or send a picture using Bluetooth.

Select **Menu** > **Photos**.

- 1 Select the folder containing the picture or video.
- 2 Select and hold the picture or video, and from the pop-up menu, select **Send** and the sending method.

Send several pictures at the same time

- 1 Select the folder containing the pictures.
- 2 Select  > **Mark**, and mark the pictures.

- 3 Select  > **Send marked** and the sending method.

Send several videos at the same time

- 1 Select the folder containing the videos.
- 2 Select **Options** > **Mark**, and mark the videos.
- 3 Select **Options** > **Send marked** and the sending method.

Web

About the web browser

Select **Menu** > **Internet**.

Catch up on the news, and visit your favourite websites. You can use the web browser to view web pages on the internet.

The web browser compresses and optimises web content for your phone, so you can browse the web more quickly and save on data costs.

To browse the web, you must be connected to the internet.

For availability, pricing, and instructions, contact your service provider.

You may receive the configuration settings required for browsing as a configuration message from your service provider.

Browse the web

Select **Menu** > **Internet**.

Tip: If you do not have a flat-rate data plan from your service provider, to save data costs in your phone bill, you can use a WLAN to connect to the internet.

View your browsing history, featured sites, or your bookmarks

To switch between the History, Featured, and Favourites tabs, swipe left or right.

Go to a website

Select the address bar, and enter the address.

Move on the web page

Drag the page with your finger.

Zoom in

Select the desired section of the web page.

Zoom out

Double-tap the screen.

Search the internet

Select the search field, and enter a search word. If prompted, select your default search engine.

Return to a previously visited web page

Open the History tab, and select the web page.

Tip: You can download web apps from Nokia Store. When you first open a web app, it is added as a bookmark. For more information, go to www.nokia.com.





Fit a web page to your phone display

Your web browser can optimise web pages for your phone display. Instead of having to zoom in, the web page is arranged into a single column of larger, readable text and pictures.

Select **Menu > Internet**.

Select  > **Tools > Column view**.

To quickly go to different sections of a web page, select from the following:

-  Go to the previous or next section of the web page.
-  Sign in to the web page.
-  Go to the main section of the web page.
-  Search the web page.
-  Read RSS feeds.

The available options may vary.

This view is not available for web sites designed for mobile use.

Add a bookmark

If you visit the same websites all the time, add them as bookmarks, so you can easily access them.

Select **Menu > Internet**.

While browsing, select  > **Add to favourites**.

Go to a bookmarked website

Open the Favourites tab, and select a bookmark.

Clear your browsing history

Select **Menu > Internet**.

Open the History tab, and select  > **Clear history**.

Clear stored cookies or text saved in web forms

Select  > **Tools > Settings > Clear cookies or Clear auto-fill**.

Keep in touch with your online friends

About Social

Select **Menu > Apps > Apps and games > Social**, and sign in to your relevant social networking services.

With the Social application, you can enhance your social networking experience. The application may not be available in all regions. When signed in to social networking services, such as Facebook or Twitter, you can do the following:

- See your friends' status updates
- Post your own status update
- Instantly share pictures you take with the camera

Only those features that are supported by the social networking service are available.

Using social networking services requires network support. This may involve the transmission of large amounts of data and related data traffic costs. For information about data transmission charges, contact your service provider.

The social networking services are third party services and not provided by Nokia. Check the privacy settings of the social networking service you are using as you may share information with a large group of people. The terms of use of the social networking service apply to sharing information on that service. Familiarise yourself with the terms of use and the privacy practices of that service.

Mail and chat

About Mail

Select **Menu > Mail**.

You can use your phone to read and send mail from your mail accounts from different mail service providers.

If you do not already have a mail account, you can create a Nokia Mail account. For more information, go to www.nokia.com/support.

Send a mail

Select **Menu** > **Mail** and a mail account.

- 1 Select **Options** > **Compose new**.
- 2 Enter the recipient's mail address and the subject, and write your message.
- 3 To attach a file, for example, a picture, select **Options** > **Attach** > **From Gallery**.
- 4 To take a picture to attach to the mail, select **Options** > **Attach** > **From Camera**.
- 5 Select **Send**.

Read and reply to mail

Select **Menu** > **Mail** and a mail account.

- 1 Select a mail.
- 2 To reply to or forward a mail, select **Options**.

About Chat

Select **Menu** > **Chat**.

You can exchange instant messages with your friends. Chat is a network service. If you do not have a chat account, you can create a Nokia account, and use Nokia's Ovi Chat.

You can leave the Chat application running in the background while you use other features of your phone, and still be notified of new instant messages.

Using services or downloading content may cause transfer of large amounts of data, which may result in data traffic costs.

Chat with your friends

Select **Menu** > **Chat**.

You can sign in to and chat in several services at the same time. You must separately sign in to each service.

You can have ongoing conversations with several contacts at the same time.

- 1 If several chat services are available, select the desired service.
- 2 Sign in to the service.
- 3 In your contacts list, select the contact you want to chat with.

- 4 Write your message in the text box at the bottom of the display.
- 5 Select **Send**.

Nokia Maps

About Maps

Select **Menu** > **Maps**.

Maps shows you what is nearby and helps you plan your route, free of charge. You can:

- View your current location
- Plan a route to a nearby place
- Search for a place or specific address, and save it
- Send your location or a place to a friend in a text message

Your phone may have a memory card with preloaded maps for your country. Insert the memory card into the phone before using Maps.

Using services or downloading content may cause transfer of large amounts of data, which may result in data traffic costs.

Contents of digital maps may sometimes be inaccurate and incomplete. Never rely solely on the content or the service for essential communications, such as in emergencies.

Download maps

If you browse to an area of the map which is not saved on your memory card, and you have an active data connection to the internet, a map for the area is automatically downloaded.

Using services or downloading content may cause transfer of large amounts of data, which may result in data traffic costs.

Tip: Save new street maps to your phone before a journey, so you can browse the maps without an internet connection when travelling. Use the Nokia Suite PC app to download the latest maps, then copy them to your phone. To download and install Nokia Suite, go to www.nokia.com/support.

View your current location on the map

Select **Menu** > **Maps** and **My position**.

Update your current location

Select **Options** > **Update position**.

Save your current location

Select **Options** > **Save as favourite**.

Tip: After finding your location, you can search for nearby places. Select **Options** > **Search nearby**.

An internet connection may be required to find your current location.

Using services or downloading content may cause transfer of large amounts of data, which may result in data traffic costs.

Find a place

Maps helps you find specific locations and addresses.

Select **Menu** > **Maps**.

- 1 Select **Search**.
- 2 Enter the name of the place or address.
- 3 Select **Go**. A list of matching places or addresses is displayed.

Refine your search

- 1 Select **Advanced** > **Find place** or **Find address**.
- 2 Define more details for your search, and follow the instructions.

Tip: To search from the entire category of places, leave all name fields blank.

Tip: If you can't find the place you are looking for, try to search from an online database. Select **Search online for**. Additional charges may apply. For details, contact your service provider.

Share your location or a place

When you want to show your friends where a place is on the map, you can send the place to them in a text message.

Select **Menu** > **Maps**.

To view the place on the map, your friends don't need to have a Nokia phone, but an internet connection is required.

- 1 Select **My position** or a place on the map and **Options** > **Send this place**.
- 2 Write your message. The address and a link to the location are automatically added.

Create a walking route

Create a walking route to a nearby place. You can view the route and all the turnings on the map before setting off.

Select **Menu** > **Maps**.

- 1 Select **Plan route**.
- 2 Select **Starting location** and a saved or recent location, a place from the map, or a specific address as the start point of your walking route. To start from your current position, select **My position**.
- 3 Select **Destination** and the end point of the walking route.
The maximum distance between the start and end points is 10 kilometres, measured in a straight line. Using ferries and some special tunnels for walking routes is restricted.
- 4 Select **Go** > **Start**.
- 5 To cancel the route, select **Options** > **Cancel route**.

Nokia Services

Availability and costs of Nokia Services

The availability of Nokia Services may vary by region.

Using services or downloading content may cause transfer of large amounts of data, which may result in data traffic costs.

To learn more, go to www.nokia.com/support.

Access Nokia Services

Select **Menu** > **Apps** > **Apps and games** and the desired service.

Find help

Support

When you want to learn more about how to use your product or you are unsure how your phone should function, read the user guide thoroughly.

You may also be interested in the Nokia Support Video channel in YouTube.

If this does not resolve your issue, do one of the following:

- Reboot your phone. Switch off the phone, and remove the battery. After about a minute, replace the battery, and switch on the phone.
- Update your phone software

- Restore the original factory settings

If your issue remains unsolved, contact Nokia for repair options. Go to www.nokia.com/repair. Before sending your phone for repair, always back up your data, as all personal data in your phone may be deleted.

Subscribe to the Tips and Offers service

Tips and Offers is a convenient service to help you get the most out of your phone, providing you with tips and support messages, as well as updates for your games and applications.

Select **Menu > Apps > Apps and games > Tips and offers**.

Text message charges may apply when you subscribe or unsubscribe. For terms and conditions, see the documentation supplied with your phone, or go to www.nokia.com/mynokia.

Keep your phone up to date

Update phone software using your phone

Want to improve the performance of your phone and get application updates and great new features? Update the software regularly to get the most out of your phone. You can also set your phone to automatically check for updates.



Warning:

If you install a software update, you cannot use the device, even to make emergency calls, until the installation is completed and the device is restarted.

Using services or downloading content may cause transfer of large amounts of data, which may result in data traffic costs.

Before starting the update, connect a charger or make sure the device battery has enough power.

Select **Menu > Settings**.



- 1 Select **Device > Device updates**.
- 2 To display the current software version and check whether an update is available, select **Current sw details**.
- 3 To download and install a software update, select **Downl. device sw**. Follow the displayed instructions.
- 4 If the installation was cancelled after the download, select **Install sw update**.

The software update may take several minutes. If there are problems with the installation, contact your network service provider.

Check for software updates automatically

Select **Automatic SW update**, and define how often to check for new software updates.

Your network service provider may send phone software updates over the air directly to your phone. For more information on this network service, contact your network service provider.

Update phone software using your PC

You can use the Nokia Suite PC app to update your phone software. You need a compatible PC, a high-speed internet connection, and a compatible USB cable to connect your phone to the PC.

To get more info and to download the Nokia Suite app, go to www.nokia.com/support.

Restore original settings

If your phone is not working properly, you can reset some settings to their original values.

- 1 End all calls and connections.
- 2 Select **Menu > Settings and Rest. fact. sett. > Settings only.**
- 3 Enter the security code.

This does not affect documents or files stored on your phone.

After restoring the original settings, your phone switches off and then on again. This may take longer than usual.

Organise files

You can move, copy, and delete files and folders, or create new folders in your phone memory or on the memory card. If you organise your files into their own folders, it might help you find the files in future.

Select **Menu > Apps > Gallery.**

Create a new folder

In the folder where you want to create a sub-folder, select **Options > Add folder.**

Copy or move a file to a folder

Select and hold the file, and from the pop-up menu, select the appropriate option.

Tip: You can also play music or videos, or view pictures in Gallery.

Back up your pictures and other content to a memory card

Want to make sure you will not lose any important files? You can back up your phone memory to a compatible memory card.

Select **Menu > Settings > Sync & backup.**

Select **Create backup.**

Restore a backup

Select **Restore backup.**

Protect the environment

Save energy

You do not need to charge your battery so often if you do the following:

- Close applications and data connections, such as your WLAN or Bluetooth connection, when not in use.
- Set your phone to enter power saver mode after the minimum period of inactivity.

- Deactivate unnecessary sounds, such as touch screen and key tones.

Recycle



When this phone has reached the end of its working life, all of its materials can be recovered as materials and energy. To guarantee the correct disposal and reuse, Nokia co-operates with its partners through a program called We:recycle. For information on how to recycle your old Nokia products and where to find collection sites, go to www.nokia.com/werecycle, or call the Nokia Care contact centre.

Recycle packaging and user guides at your local recycling scheme.



The crossed-out wheeled-bin symbol on your product, battery, literature, or packaging reminds you that all electrical and electronic products, batteries, and accumulators must be taken to separate collection at the end of their working life. This requirement applies in the European Union. Do not dispose of these products as unsorted municipal waste. For more information on the environmental attributes of your phone, go to www.nokia.com/ecoprofile.

Product and safety information

Network services and costs

Your device is approved for use on the WCDMA 850/900/1700/1900/2100 (Pentaband, HSPA) and EGSM 850/900/1800/1900 (Quadband).

To use the device, you need a subscription with a service provider.

Using network services and downloading content to your device requires a network connection and may result in data traffic costs. Some product features require support from the network, and you may need to subscribe to them.

Take care of your device

Handle your device, battery, charger and accessories with care. The following suggestions help you protect your warranty coverage.

- Keep the device dry. Precipitation, humidity, and all types of liquids or moisture can contain minerals that corrode electronic circuits. If your device gets wet, remove the battery, and allow the device to dry.
- Do not use or store the device in dusty or dirty areas. Moving parts and electronic components can be damaged.
- Do not store the device in high temperatures. High temperatures can shorten the life of the device, damage the battery, and warp or melt plastics.

- Do not store the device in cold temperatures. When the device warms to its normal temperature, moisture can form inside the device and damage electronic circuits.
- Do not attempt to open the device other than as instructed in the user guide.
- Unauthorised modifications may damage the device and violate regulations governing radio devices.
- Do not drop, knock, or shake the device. Rough handling can break internal circuit boards and mechanics.
- Only use a soft, clean, dry cloth to clean the surface of the device.
- Do not paint the device. Paint can clog moving parts and prevent proper operation.
- Switch off the device and remove the battery from time to time for optimum performance.
- Keep your device away from magnets or magnetic fields.
- To keep your important data safe, store it in at least two separate places, such as your device, memory card, or computer, or write down important information.

During extended operation, the device may feel warm. In most cases, this is normal. If you suspect the device is not working properly, take it to the nearest authorised service facility.

Recycle

Always return your used electronic products, batteries, and packaging materials to dedicated collection points. This way you help prevent uncontrolled waste disposal and promote the recycling of materials. Check how to recycle your Nokia products at www.nokia.com/recycling.

About Digital Rights Management

When using this device, obey all laws and respect local customs, privacy and legitimate rights of others, including copyrights. Copyright protection may prevent you from copying, modifying, or transferring pictures, music, and other content.

Content owners may use different types of digital rights management (DRM) technologies to protect their intellectual property, including copyrights. This device uses various types of DRM software to access DRM-protected content. With this device you can access content protected with WMDRM 10 and OMA DRM 2.0. If certain DRM software fails to protect the content, content owners may ask that such DRM software's ability to access new DRM-protected content be revoked. Revocation may also prevent renewal of such DRM-protected content already in your device. Revocation of such DRM software does not affect the use of content protected with other types of DRM or the use of non-DRM-protected content.

Digital rights management (DRM) protected content comes with an associated licence that defines your rights to use the content.

If your device has OMA DRM-protected content, to back up both the licences and the content, use the backup feature of Nokia Suite.

Other transfer methods may not transfer the licences which need to be restored with the content for you to be able to continue the use of OMA DRM-protected content after the device memory is formatted. You may also need to restore the licences if the files on your device become corrupted.

If your device has WMDRM-protected content, both the licences and the content are lost if the device memory is formatted. You may also lose the licences and the content if the files on your device become corrupted. Losing the licences or the content may limit your ability to use the same content on your device again. For more information, contact your service provider.

Batteries and chargers

Battery and charger information

Your device is intended for use with a BP-3L rechargeable battery. Nokia may make additional battery models available for this device. Always use original Nokia batteries.

This device is intended for use when supplied with power from the following chargers: AC-3, AC-8, AC-10, AC-11, AC-15. The exact Nokia charger model number may vary depending on the plug type, identified by E, X, AR, U, A, C, K, or B.

The battery can be charged and discharged hundreds of times, but it will eventually wear out. When the talk and standby times are noticeably shorter than normal, replace the battery.

Battery safety

Always switch the device off and disconnect the charger before removing the battery. When you unplug a charger or an accessory, hold and pull the plug, not the cord.

When your charger is not in use, unplug it from the electrical plug and the device. Do not leave a fully charged battery connected to a charger, as overcharging may shorten the battery's lifetime. If left unused, a fully charged battery will lose its charge over time.

Always keep the battery between 15°C and 25°C (59°F and 77°F). Extreme temperatures reduce the capacity and lifetime of the battery. A device with a hot or cold battery may not work temporarily.

Accidental short-circuiting can happen when a metallic object touches the metal strips on the battery, for example, if you carry a spare battery in your pocket. Short-circuiting may damage the battery or the connecting object.

Do not dispose of batteries in a fire as they may explode. Dispose of batteries according to local regulations. Recycle when possible. Do not dispose as household waste.

Do not dismantle, cut, open, crush, bend, puncture, or shred cells or batteries. If a battery leaks, do not let battery liquid touch skin or eyes. If this happens, immediately flush the affected areas with water, or seek medical help.

Do not modify, remanufacture, attempt to insert foreign objects into the battery, or immerse or expose it to water or other liquids. Batteries may explode if damaged.

Use the battery and charger for their intended purposes only. Improper use, or use of unapproved batteries or incompatible chargers may present a risk of fire, explosion, or other hazard, and may invalidate any approval or warranty. If you believe the battery or charger is damaged, take it to a service centre for inspection before continuing to use it. Never use a damaged battery or charger. Only use the charger indoors.

Additional safety information**Make an emergency call**

- 1 Make sure the device is switched on.
- 2 Check for adequate signal strength. You may also need to do the following:
 - Insert a SIM card.
 - Deactivate call restrictions you have activated for your device, such as call barring, fixed dialling, or closed user group.
 - Make sure the flight profile is not activated.
 - If the device screen and keys are locked, unlock them.
- 3 Press the end key repeatedly, until the home screen is displayed.
- 4 Enter the official emergency number for your present location. Emergency call numbers vary by location.
- 5 Press the call key.
- 6 Give the necessary information as accurately as possible. Do not end the call until given permission to do so.



Important: Activate both cellular and internet calls, if your device supports internet calls. The device may attempt to make emergency calls both through cellular networks and through your internet call service provider. Connections in all conditions cannot be guaranteed. Never rely solely on any wireless device for essential communications like medical emergencies.

Small children

Your device and its accessories are not toys. They may contain small parts. Keep them out of the reach of small children.

Medical devices

Operation of radio transmitting equipment, including wireless phones, may interfere with the function of inadequately protected medical devices. Consult a physician or the manufacturer of the medical device to determine whether they are adequately shielded from external radio frequency energy.

Implanted medical devices

Manufacturers of medical devices recommend a minimum separation of 15.3 centimetres (6 inches) between a wireless device and an implanted medical device, such as a pacemaker or implanted cardioverter defibrillator, to avoid potential interference with the medical device. Persons who have such devices should:

- Always keep the wireless device more than 15.3 centimetres (6 inches) from the medical device.
- Not carry the wireless device in a breast pocket.
- Hold the wireless device to the ear opposite the medical device.
- Turn the wireless device off if there is any reason to suspect that interference is taking place.
- Follow the manufacturer directions for the implanted medical device.

If you have any questions about using your wireless device with an implanted medical device, consult your health care provider.

Hearing



When you use the headset, your ability to hear outside sounds may be affected. Do not use the headset where it can endanger your safety.

Some wireless devices may interfere with some hearing aids.

Nickel

The surface of this device is nickel-free.

Protect your device from harmful content

Your device may be exposed to viruses and other harmful content. Take the following precautions:

- Be cautious when opening messages. They may contain malicious software or otherwise be harmful to your device or computer.
- Be cautious when accepting connectivity requests, browsing the internet, or downloading content. Do not accept Bluetooth connections from sources you do not trust.
- Only install and use services and software from sources that you trust and that offer adequate security and protection.
- Install antivirus and other security software on your device and any connected computer. Only use one antivirus application at a time. Using more may affect performance and operation of the device and/or computer.
- If you access preinstalled bookmarks and links to third party internet sites, take the appropriate precautions. Nokia does not endorse or assume liability for such sites.

Operating environment

This device meets radio frequency exposure guidelines in the normal use position at the ear or at least 1.5 centimetres (5/8 inch) away from the body. Any carry case, belt clip, or holder for body-worn operation should not contain metal and should position the device the above-stated distance from your body.

To send data files or messages requires a quality connection to the network. Data files or messages may be delayed until such a connection is available. Follow the separation distance instructions until the transmission is completed.

Vehicles

Radio signals may affect improperly installed or inadequately shielded electronic systems in motor vehicles such as electronic fuel injection, electronic antilock braking, electronic speed control, and air bag systems. For more information, check with the manufacturer of your vehicle or its equipment.

Only qualified personnel should install the device in a vehicle. Faulty installation or service may be dangerous and may invalidate your warranty. Check regularly that all wireless device equipment in your vehicle is mounted and operating properly. Do not store or carry flammable liquids, gases, or explosive materials in the same compartment as the device, its parts, or accessories. Remember that air bags inflate with great force. Do not place your device or accessories in the air bag deployment area.

Potentially explosive environments

Switch off your device in any area with a potentially explosive atmosphere, for example near gas pumps at service stations. Sparks in such areas could cause an explosion or fire resulting in bodily injury or death. Observe restrictions in fuel service stations, storage, and distribution areas; chemical plants; or where blasting operations are in progress. Areas with a potentially explosive atmosphere are often, but not always, clearly marked. They include areas where you would be advised to turn off your vehicle engine, below deck on boats, chemical transfer or storage facilities and where the air contains chemicals or particles such as grain, dust, or metal powders. You should check with the manufacturers of vehicles using liquefied petroleum gas (such as propane or butane) to determine if this device can be safely used in their vicinity.

Certification information (SAR)

This mobile device meets guidelines for exposure to radio waves.

Your mobile device is a radio transmitter and receiver. It is designed not to exceed the limits for exposure to radio waves recommended by international guidelines. These guidelines were developed by the independent scientific organisation ICNIRP and include safety margins designed to assure the protection of all persons, regardless of age and health.

The exposure guidelines for mobile devices employ a unit of measurement known as the Specific Absorption Rate or SAR. The SAR limit stated in the ICNIRP guidelines is 2.0 watts/kilogram (W/kg) averaged over 10 grams of tissue. Tests for SAR are conducted using standard operating positions with the device transmitting at its highest certified power level in all tested frequency bands. The actual SAR level of an operating device can be below the maximum value because the device is designed to use only the power required to reach the network. That amount changes depending on a number of factors such as how close you are to a network base station.

The highest SAR value under the ICNIRP guidelines for use of the device at the ear is 0.79 W/kg.

Use of device accessories may result in different SAR values. SAR values may vary depending on national reporting and testing requirements and the network band. Additional SAR information may be provided under product information at www.nokia.com.

Copyright and other notices

DECLARATION OF CONFORMITY

CE 0434 

Hereby, NOKIA CORPORATION declares that this RM-763 product is in compliance with the essential requirements and other relevant provisions of Directive 1999/5/EC. A copy of the Declaration of Conformity can be found at <http://www.nokia.com/global/declaration>.

© 2011 Nokia. All rights reserved.

Nokia, Nokia Connecting People, Ovi, and WE: logo are trademarks or registered trademarks of Nokia Corporation. Nokia tune is a sound mark of Nokia Corporation. Other product and company names mentioned herein may be trademarks or tradenames of their respective owners.

Reproduction, transfer, distribution, or storage of part or all of the contents in this document in any form without the prior written permission of Nokia is prohibited. Nokia operates a policy of continuous development. Nokia reserves the right to make changes and improvements to any of the products described in this document without prior notice.



Includes RSA BSAFE cryptographic or security protocol software from RSA Security.



Oracle and Java are registered trademarks of Oracle and/or its affiliates.

Portions of the Nokia Maps software are ©1996-2011 The FreeType Project. All rights reserved.

The Bluetooth word mark and logos are owned by the Bluetooth SIG, Inc. and any use of such marks by Nokia is under license.

This product is licensed under the MPEG-4 Visual Patent Portfolio License (i) for personal and noncommercial use in connection with information which has been encoded in compliance with the MPEG-4 Visual Standard by a consumer engaged in a personal and noncommercial activity and (ii) for use in connection with MPEG-4 video provided by a licensed video provider. No license is granted or shall be implied for any other use. Additional information, including that related to promotional, internal, and commercial uses, may be obtained from MPEG LA, LLC. See <http://www.mpegla.com>.

To the maximum extent permitted by applicable law, under no circumstances shall Nokia or any of its licensors be responsible for any loss of data or income or any special, incidental, consequential or indirect damages howsoever caused.

The contents of this document are provided "as is". Except as required by applicable law, no warranties of any kind, either express or implied, including, but not limited to, the implied warranties of merchantability and fitness for a particular purpose, are made in relation to the accuracy, reliability or contents of this document. Nokia reserves the right to revise this document or withdraw it at any time without prior notice.

The availability of products, features, applications and services may vary by region. For more information, contact your Nokia dealer or your service provider. This device may contain commodities, technology or software subject to export laws and regulations from the US and other countries. Diversion contrary to law is prohibited.

Nokia does not provide a warranty for or take any responsibility for the functionality, content, or end-user support of third-party applications provided with your device. By using an application, you acknowledge that the application is provided as is. Nokia does not make any representations, provide a warranty, or take any responsibility for the functionality, content, or end-user support of third-party applications provided with your device.

The availability of Nokia services may vary by region.

FCC/INDUSTRY CANADA NOTICE

Your device may cause TV or radio interference (for example, when using a telephone in close proximity to receiving equipment). The FCC or Industry Canada can require you to stop using your telephone if such interference cannot be eliminated. If you require assistance, contact your local service facility. This device complies with part 15 of the FCC rules and Industry Canada licence-exempt RSS standard(s). Operation is subject to the following two conditions: (1) This device may not cause harmful interference, and (2) this device must accept any interference received, including interference that

may cause undesired operation. Any changes or modifications not expressly approved by Nokia could void the user's authority to operate this equipment.

Some operations and features are SIM card and/or network dependent, MMS dependent, or dependent on the compatibility of devices and the content formats supported. Some services are subject to a separate charge.

/Issue 1.1 EN

Index**A**

access codes	11
alarm clock	23
alarms	23
antennas	11

B

backing up data	40
battery	6, 42, 43
— charging	9
Bluetooth	24
bookmarks	32
browser	
<i>See web browser</i>	
business cards	24

C

cable connection	25
Calendar	23
calls	
— emergency	43
— internet calls	16
— log	15
— making	15
camera	
— recording videos	30
— sending pictures and videos	30
— taking pictures	30
charging the battery	42
chat services (IM)	34
clock	23
connectivity	26
contacts	
— adding	17
— copying	14
— saving	17
conversations	20
copying content	14, 25

D

data connections	
— Bluetooth	24
— WLAN	26
date and time	23

E

e-mail	33
emergency calls	43
environmental tips	40

F

factory settings, restoring	39
file management	40
FM radio	27, 28

H

home screen	21
-------------	----

I

IM (instant messaging)	34
IMEI number	11
inbox, messages	20
indicators	14
internet	
<i>See web browser</i>	
internet calls	16

K

keyboard	5, 18
keyguard	12
keys and parts	5

L

lock code	11
locking	
— keys	12
— screen	12
loudspeaker	15

M

mail	33
— creating	34
— reading and replying to	34
— sending	34
mailbox	
— voice	20
Maps	35
— creating routes	37
— current location	35
— downloading maps	35
— searching	36
— sharing	36
media key	29
meeting entries	23
memory card	8
messages	20
— audio	21
— sending	19
messaging key	20
MMS (multimedia message service)	19
multimedia messages	19
music	29

N

Nokia Services	37
Nokia support information	37

P

personalising your phone	21, 22
phone	
— switching on/off	10
Phone switch	14
pictures	
— copying	14, 25
— sending	24, 30
— taking	30
PIN codes	11
powering on/off	10
predictive text input	19

profiles

— personalising	22
PUK codes	11

R

radio	27, 28
recording	
— videos	30
recycling	40
restoring data	40
restoring settings	39
ringtones	22

S

searching	
— radio stations	28
security code	11
settings	
— restoring	39
SIM card	6
SMS (short message service)	19
social networks	33
software updates	38, 39
speed dialling	17
strap	10
support	37
switching on/off	10

T

taking pictures	
See <i>camera</i>	
text input	5, 18, 19
text messages	19
themes	21
time and date	23
Tips and Offers	38
tones	
— personalising	22
touch screen	12
transferring content	14, 25
turning on/off	10

U

updates

- phone software 38, 39

USB connection 25

V

videos

- copying 14, 25

- playing 29

- recording 30

- sending 24, 30

voice messages 20

volume 15

W

web browser 31

- bookmarks 32

- browsing pages 31, 32

- cookies 33

WLAN (wireless local area network) 26, 27