



USER'S MANUAL

Convertible Type Series

Ceiling/Floor : AVXTF22

ENGLISH

ESPAÑOL

FRANÇAIS

ITALIANO

DEUTSCH

System Air Conditioner (Cooling and Heating)

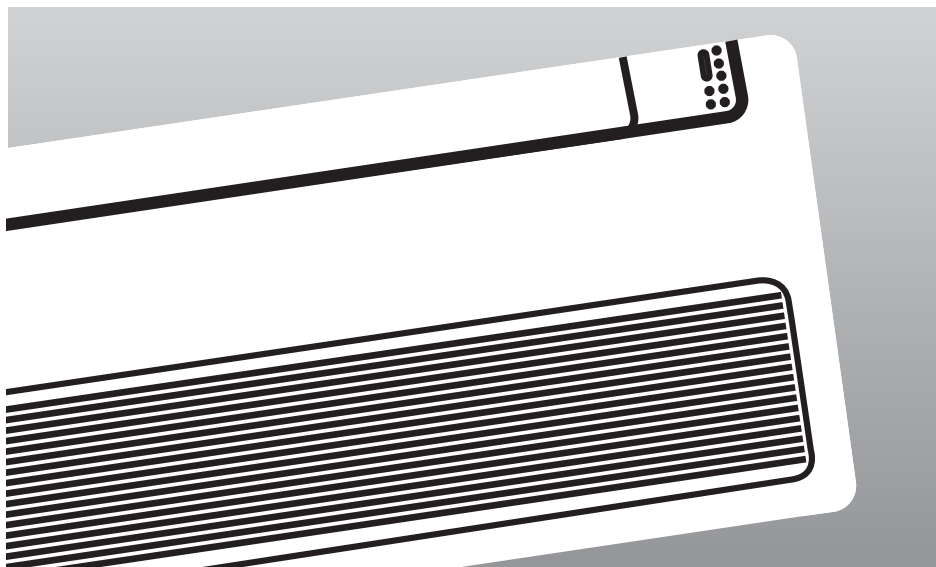

Contents

➤ PREPARING YOUR AIR CONDITIONER	
↳ Safety Precautions	3
↳ View of the Indoor unit	8
➤ RECOMMENDATIONS FOR USE	
↳ Adjusting the Air Flow Direction	9
↳ Operating Recommendations	10
↳ Temperature and Humidity Ranges	11
↳ Cleaning Your Air Conditioner	12
↳ Solving Common Problems	13



Correct Disposal of This Product (Waste Electrical & Electronic Equipment)

(Applicable in the European Union and other European countries with separate collection systems)

This marking shown on the product or its literature, indicates that it should not be disposed with other household wastes at the end of its working life. To prevent possible harm to the environment or human health from uncontrolled waste disposal, please separate this from other types of wastes and recycle it responsibly to promote the sustainable reuse of material resources.

Household users should contact either the retailer where they purchased this product, or their local government office, for details of where and how they can take this item for environmentally safe recycling.

Business users should contact their supplier and check the terms and conditions of the purchase contract.

This product should not be mixed with other commercial wastes for disposal.

Register your product at www.samsung.com/global/register

Safety Precautions

You should take the following safety precautions when using your air conditioner.



WARNING

- Risk of electric shock can cause injury or death.
- Disconnect all remote electric power supplies before servicing, installing or cleaning.
- Installation must be done by the manufacturer or service agent or a similar qualified person in order to avoid a hazard.

WHEN INSTALLING

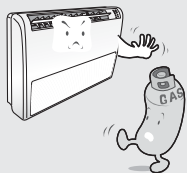

- ▶ Do not install the air conditioner where there's combustible gas.



- ▶ Do not install the outdoor unit where there's the risk of dropping such as on high outer wall or outside of the terrace.

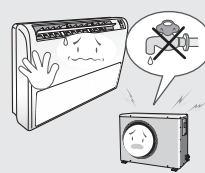

- ▶ Earth the ground conductor and do not connect it to the gas pipe, water pipe or telephone wire.

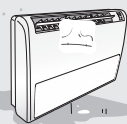

- ▶ Contact the service center if the air conditioner is under water.

REGARDING POWER SOURCE



- ▶ Do not pull the electric wire or touch the power plug with the wet hands.



- ▶ Install the switch and circuit breaker only for air conditioner.

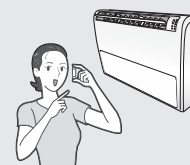

- ▶ Use the rated current fuse.



- ▶ Do not bend the electric wire by force or weigh down the air conditioner not to be out of order.

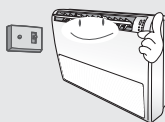

- ▶ Use the power source with separate wiring only for air conditioner.



- ▶ If the power plug is damaged, replace it by the manufacturer or qualified personal to avoid the risk.



WARNING

DURING OPERATION



- Users of this product are cautioned not to attempt repair of this product at their own discretion. Instead, they are requested to directly contact a designated service center or the outlet at which the product was purchased.

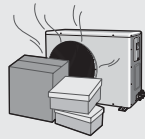

- Do not place any obstacles in front of the unit. Make sure that the unit is correctly ventilated at all times: Do not place clothing or other materials over it.



- Do not place any materials so that children cannot step on it.

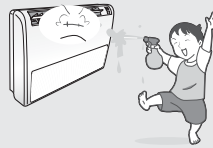

- Never spill any kind of liquid into the unit. Should this happen, unplug or main switch off the unit and contact an authorized service center.

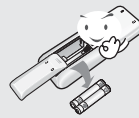

- If the wireless remote control is not used for a long time, remove the batteries. (If applicable)

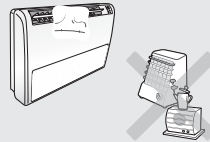

- Do not connect the electric heater to the air conditioner or repair it with your discretion.



- Do not insert anything between the air outlet blades because the inner fan may be damaged and could cause injury. Keep children away from the unit.

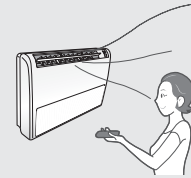

- When using a wireless remote control, the distance should not be more than 7 meters from the air conditioner. (If applicable)

WARNING

DISPOSING THE UNIT

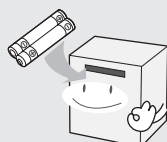

- Before throwing out the device, it is necessary to pull back the battery cells and get rid of them safely for recycling reasons.

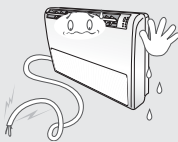

- When you need to dispose of the unit, consult your dealer. If pipes are removed incorrectly, refrigerant may blow out and come into contact with your skin, causing injury. Releasing refrigerant into the atmosphere also damages the environments.



- Please recycle or dispose of the packaging material for this product in an environmentally responsible manner.

CAUTION

WHEN INSTALLING

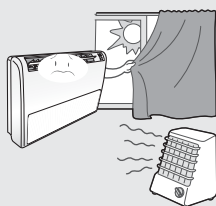

- Install the air conditioner avoiding direct sunlight or heater, especially water.

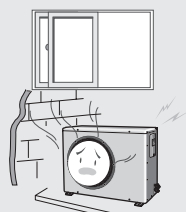

- Install the outdoor unit so as to let the discharged air out properly. Avoid a place that may disturb your neighbor by noise.

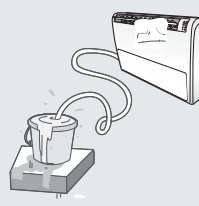

- Install the drain hose to let the water run safely and correctly.



- Install the outdoor unit not to reach heat to the passage or higher than 2m from the ground when installing it on the road.



CAUTION

REGARDING POWER SOURCE



- ▶ Disconnect the circuit breaker when you don't use the air conditioner for a long time to save energy.



- ▶ Contact the service center or manufacturer if you want to repair the air conditioner.



- ▶ Contact the service center after turning off the air conditioner if strange noise is heard, burning smell or smoke blow.

DURING OPERATION



- ▶ Do not open the front grille during operation.



- ▶ Avoid cold and hot air reaching to person, pet or a plant directly for a long time.



- ▶ Avoid the water from getting into the air conditioner.



- ▶ Do not use the air conditioner for a long time in a closed room or in a place where there's a baby or an old person.



- ▶ Do not step on the air conditioner or put heavy object on it.



- ▶ Do not drink the water from the air conditioner.

CAUTION

DURING OPERATION

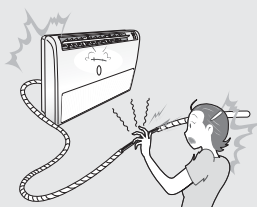

- Do not touch the pipes connected to the air conditioner.



- Do not use the air conditioner to maintain the machine, food, pet, plant or cosmetics.



- Do not give excessive shock to the air conditioner.

OTHERS



- Be sure that the air filter not to be exposed to direct sunlight.



- The appliance is not intended for use by young children or infirm persons without supervision: Young children should be supervised to ensure that they do not play with the appliance.



- Max current is measured according to IEC standard for safety and current is measured according to ISO standard for energy efficiency.



- Turn off the air conditioner and if the fan stops to operate, clean the air conditioner.



- Do not clean the air conditioner by spraying water directly or with benzene, thinner or alcohol.

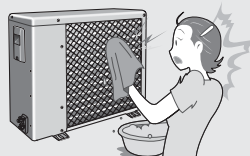

- The surface of the heat exchanger is sharp, so be careful of it when cleaning.



- Clean the air filter every 2 weeks.



- Be sure to insert the air filter.

View of the Indoor Unit

The design and shape are subject to change according to the model.

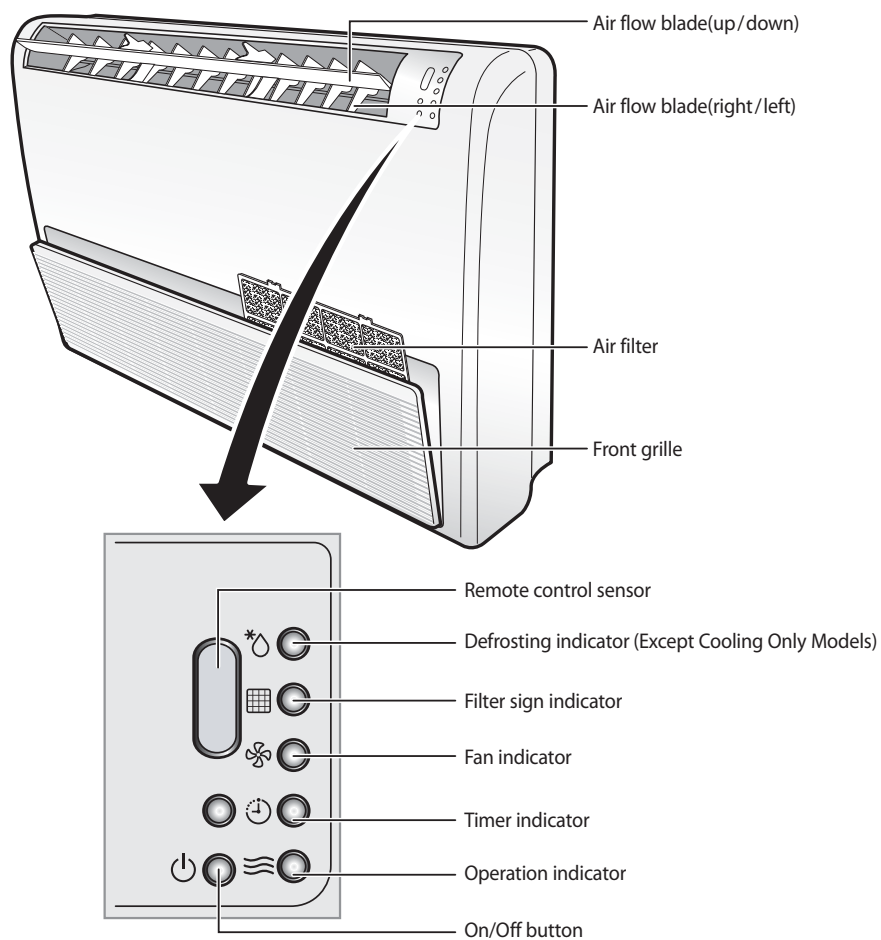

Adjusting the Air Flow Direction

There are two sets of inner air flow blades. Just as the outer air flow blade can be adjusted vertically, the inner blades can be adjusted horizontally.

Adjust each set of inner blades to the required position, by pushing or pulling them sideways.

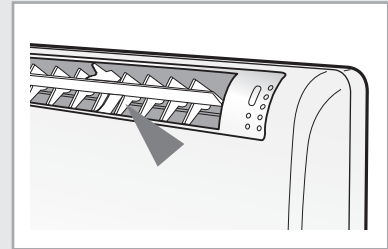

Operating Recommendations

Here are a few recommendations that you should follow when operating your air conditioner.

Topic	Recommendation
Heating performances	<p>The heat pump function of the air conditioner absorbs heat from outside air and brings it indoors. As the temperature of the outside air drops, the heating performance of air conditioner will decrease.</p> <p>If you find that the room is not warm enough, using an additional heating appliance is recommended.</p>
Frost & Defrost	<p>When outside temperature is low but humidity is high, frost may form on the outdoor unit at HEAT mode.</p> <p>If this happens:</p> <ul style="list-style-type: none">⇨ The heating operation stops.⇨ The defrost mode will be triggered automatically for about 10 minutes.⇨ The steam produced on the outdoor unit in the defrost mode is safe. <p>No intervention is required ; after about 10 minutes, the air conditioner operates again normally.</p>
High indoor and outdoor temperatures	<p>If both indoor and outdoor temperatures are high and the air conditioner is running at HEAT mode, the outdoor unit's fan and compressor may stop at times.</p> <p>This is normal ; simply wait until the air conditioner switches on again.</p>
Power failure	<p>If a power failure occurs while the air conditioner is operating, the unit will be switched off.</p> <p>When the power returns, the air conditioner starts up again automatically.</p>

Temperature and Humidity Ranges

The following table indicates the temperature and humidity ranges, within which the air conditioner can be used.

If the air conditioner is used at...	Then...
High temperature	The automatic protection feature may be triggered and the air conditioner stopped.
Low temperature	A water leakage or some other malfunction may happen if the heat exchanger freezes.
High humidity levels	Water may condense on and drip from the surface of the indoor unit if it is used for a long periods.

Mode	Outdoor Temperature	Indoor Temperature	Indoor Humidity
Heating	-20°C to 24°C approx.	27°C or less	-
Cooling	-5°C to 43°C approx.	21°C to 32°C approx.	80% or less
Drying	-5°C to 43°C approx.	21°C to 32°C approx.	-

→ **The standardized temperature for heating is 7°C. If the outdoor temperature drops to 0°C or below, the heating capacity can be reduced depending on the temperature condition.**
If the cooling operation is used at over 32°C(indoor temperature), it does not cool at its full capacity.

Cleaning Your Air Conditioner

To get the best possible use out of your air conditioner, you must to clean it to remove the dust that accumulates on the air filters.



Before cleaning your air conditioner, ensure that you have switched off the breaker used for the unit.

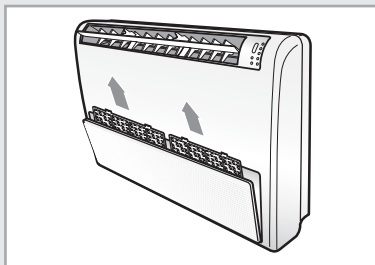
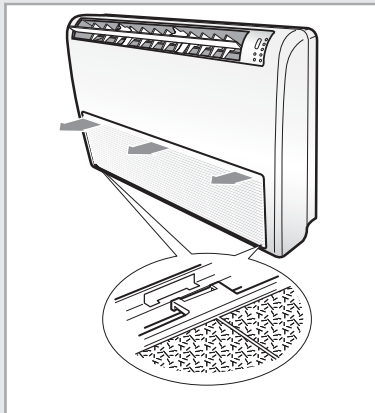

- 1 Open the front grille by pushing on both sides and center.
- 2 Pull the air filters in upward direction to remove them.
Remove all dust from the air filters by vacuum cleaner, brush or by washing them with a detergent and warm water below 40°C.
After washing, allow them to dry thoroughly in an area protected from sunlight.
- 3 Insert the air filters to the front grille.
- 4 Close the front grille by pushing both sides and center.

Note

- ✦ **If you have not used the air conditioner for a long period of time, set the fan going for three or four hours to dry the inside of the air conditioner thoroughly.**
- ✦ **If you don't clean the air filter at least every two weeks, its performance may be reduced and noise may increase.**
- ✦ **After cleaning the air conditioner, press the Filter Reset button.**

Wired Remote Controller

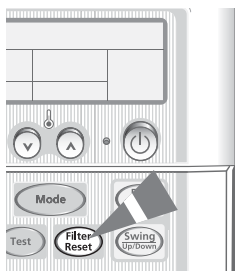



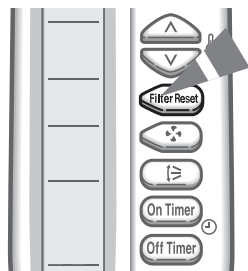



Wireless Remote Controller



Solving Common Problems

Before contacting the after-sales service, perform the following simple checks.
They may save your time and expense of an unnecessary call.

Problem	Explanation/Solution
The air conditioner does not operate at all.	<ul style="list-style-type: none"> ⇒ Check if power is on and operate the air conditioner again. ⇒ Check if the circuit breaker is switched off. ⇒ Check if Off Timer is set.
The temperature is not adjusted.	<ul style="list-style-type: none"> ⇒ Check if you selected the Fan mode.
The air conditioner does not operate in the HEAT mode.	<ul style="list-style-type: none"> ⇒ Check if the air conditioner is cooling only model. ⇒ Check if the remote control is for cooling only model.
The cool(warm) air does not come out from the air conditioner.	<ul style="list-style-type: none"> ⇒ Check if set temperature higher(lower) than current temperature. ⇒ Check if you selected the Fan mode. Select the Cool, Heat, Auto or Dry mode. ⇒ Check if the air filter is blocked by dirt. Clean the air filter regularly. ⇒ Check if there is cover on the outdoor unit or any obstacle. Remove the cover or obstacle. ⇒ Check if you installed the air conditioner under direct sunlight. ⇒ The window or door may be opened. ⇒ Check if you turn on the air conditioner just now. It takes about 3 minutes to cool or heat the room. ⇒ Check if the refrigerant pipe is too long.
The fan speed is not adjusted.	<ul style="list-style-type: none"> ⇒ In Auto or Dry mode, the fan speed is selected automatically.
The remote control does not operate.	<ul style="list-style-type: none"> ⇒ Check if the battery is discharged. Replace the battery. ⇒ Check if the remote control sensor is blocked. ⇒ Check if the air conditioner is placed near strong light.
The wired remote control does not operate.	<ul style="list-style-type: none"> ⇒ Check if  is displayed on the wired remote control. Turn off the air conditioner and switch off the circuit breaker. Contact the service center.
The Timer is not set.	<ul style="list-style-type: none"> ⇒ Check if you pressed the  or  button after selecting time.
The air conditioner does not turn on or off with the wired remote control.	<ul style="list-style-type: none"> ⇒ Check if you set the wired remote control for group control.
Odor is permeated in the room during operation	<ul style="list-style-type: none"> ⇒ Check if you use the air conditioner in smoky area or there is a smell. Ventilate the room or select the Fan mode for 1~2 hours.
The indoor unit indicator flashes.	<ul style="list-style-type: none"> ⇒ Press the  button to turn on the air conditioner again. Switch the circuit breaker off and switch on it again.
Strange sound is heard from the air conditioner.	<ul style="list-style-type: none"> ⇒ The sound is heard when the refrigerant gas flow is changed depending on the use of the air conditioner. ⇒ When you press the  button, noise may be heard from the drain pump inside of the air conditioner. ⇒ When you press the  button, noise may be heard that the air conditioner sense the airflow blade.
Water drops from the outdoor unit connection part.	<ul style="list-style-type: none"> ⇒ Water may form due to the difference of the temperature.



Contact SAMSUNG WORLD WIDE

If you have any comments or questions regarding a Samsung products, contact the SAMSUNG customer care center.

Country	Customer Care Center ☎	Web Site
BELGIUM	02 201 2418	www.samsung.com/be
CZECH REPUBLIC	844 000 844	www.samsung.com/cz
DENMARK	38 322 887	www.samsung.com/dk
FINLAND	09 693 79 554	www.samsung.com/fi
FRANCE	08 25 08 65 65 (0,15€/min)	www.samsung.com/fr
GERMANY	01805 - 121213 (€0,12/min)	www.samsung.de
HUNGARY	06 40 985 985	www.samsung.com/hu
ITALIA	199 153 153	www.samsung.com/it
LUXEMBURG	02 261 03 710	www.samsung.lu
NETHERLANDS	0900 20 200 88 (€0.10/min)	www.samsung.com/nl
NORWAY	231 627 22	www.samsung.com/no
POLAND	0 801 801 881	www.samsung.com/pl
PORTUGAL	80 8 200 128	www.samsung.com/pt
SLOVAKIA	0850 123 989	www.samsung.com/sk
SPAIN	902 10 11 30	www.samsung.com/es
SWEDEN	08 585 367 87	www.samsung.com/se
U.K	0870 242 0303	www.samsung.com/uk