

FP402010 MUK Rev 3

morphy richards®

smart ideas for your home



Accents Hand Blender Set

Please read and keep these instructions for future use

FEATURING
SERRATOR
BLADE

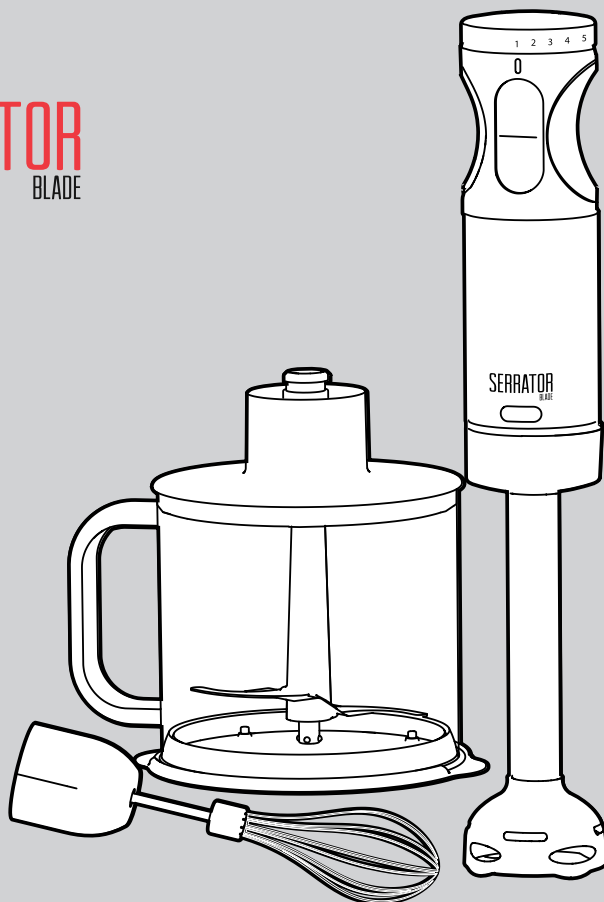

For competitions, product hints and tips
and more join us at



www.morphyrichards.co.uk/blog



www.facebook.com/morphyrichardsuk



[@loveyourmorphy](https://twitter.com/loveyourmorphy)

www.morphyrichards.com

* Register online for your 2 year guarantee. See the back of this instruction book for details (UK and Ireland customers only).

** Applies to serrator blade only. See back of this instruction book for details.

*** Independently tested by CATRA using the International Standard Cutting Test System to ISO 8442.5 vs a standard plain edge blade.

Health and Safety

The use of any electrical appliance requires the following common sense safety rules.
Please read these instructions carefully before using the product.

- This appliance can be used by persons with reduced physical, sensory or mental capabilities, or lack of experience and knowledge, if they have been given supervision or instruction concerning the use of the appliance in a safe way and understand the hazards involved.
- Avoid touching moving parts. Keep hands, hair and clothing, and utensils away from the attachment blades during operation, to prevent personal injury and/or damage to the appliance.
- Always disconnect from the supply if it left unattended and before assembling, disassembling or cleaning.
- Switch off the appliance and disconnect from supply before changing accessories or approaching parts that move in use.
- Do not blend for longer than the time periods recommended in 'Usage' on page 5.
- Children shall not play with the appliance.
- This appliance shall not be used by children.
- Keep the appliance and cord out of reach of children.

In addition, we offer the following safety advice.

Location

- Do not use outdoors or in a bathroom.
- Always locate your appliance away from the edge of the worktop.
- Do not place the bowl used with the appliance on a highly polished wooden surface as damage may occur to the surface.

Mains cable

- Do not let the mains cable hang over the edge of the worktop where a child could reach it.
- Do not let the lead run across an open space e.g. between a low socket and a table.
- Do not let the cable run across a cooker or other hot area which might damage the cable.
- The mains cable should reach from the socket to the base unit without straining the connections.
- The power cord cannot be replaced. Contact Morphy Richards for advice.

Personal safety

- Avoid touching moving parts. Keep hands, hair and clothing, and utensils away from the attachment blades during operation, to prevent personal injury and/or damage to the appliance.

- Care shall be taken when handling the sharp cutting blades, emptying the bowl and during cleaning.

Other safety considerations

- Do not use the appliance for anything other than it's intended purpose.

Product specific safety

- **WARNING:** The blender blades are very sharp. Handle with care when using and cleaning.
- Do not clean the attachments under running water while they are in position.
- **IMPORTANT:** Allow hot liquids to cool before adding to the blender, always ensure the lid is fitted correctly.
- Do not exceed maximum quantities listed on page 8.
- For cleaning refer to page 7.
- Be careful whilst hot liquid is blending or poured into the blender as it can be ejected due to sudden steaming.

Electrical requirements

Check that the voltage on the rating plate of your appliance corresponds with your house electricity supply which must be A.C. (Alternating Current).

Should the fuse in the mains plug require changing, a 3 amp BS1362 fuse must be fitted.

FEATURING SERRATOR BLADE

STAYS SHARPER
12x LONGER
THAN STANDARD BLADES

Congratulations on choosing your new Morphy Richards food preparation appliance with Serrator Blade technology. With its revolutionary, unique design the Serrator Blade is designed to give you superior cutting performance for longer.

How does the Serrator blade work?

Specially developed by our in-house designers the Serrator Blade has been created to outperform standard plain edge blades. The perfect serration has been carefully selected and rigorously tested to give you superior performance and us the confidence that the Serrator Blade will give you years of satisfaction.

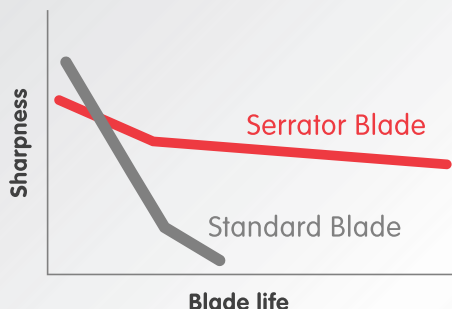

Our new precision Serrator Blades **stay sharper up to 12x longer** than standard blades, maintaining performance for life.



Product overview

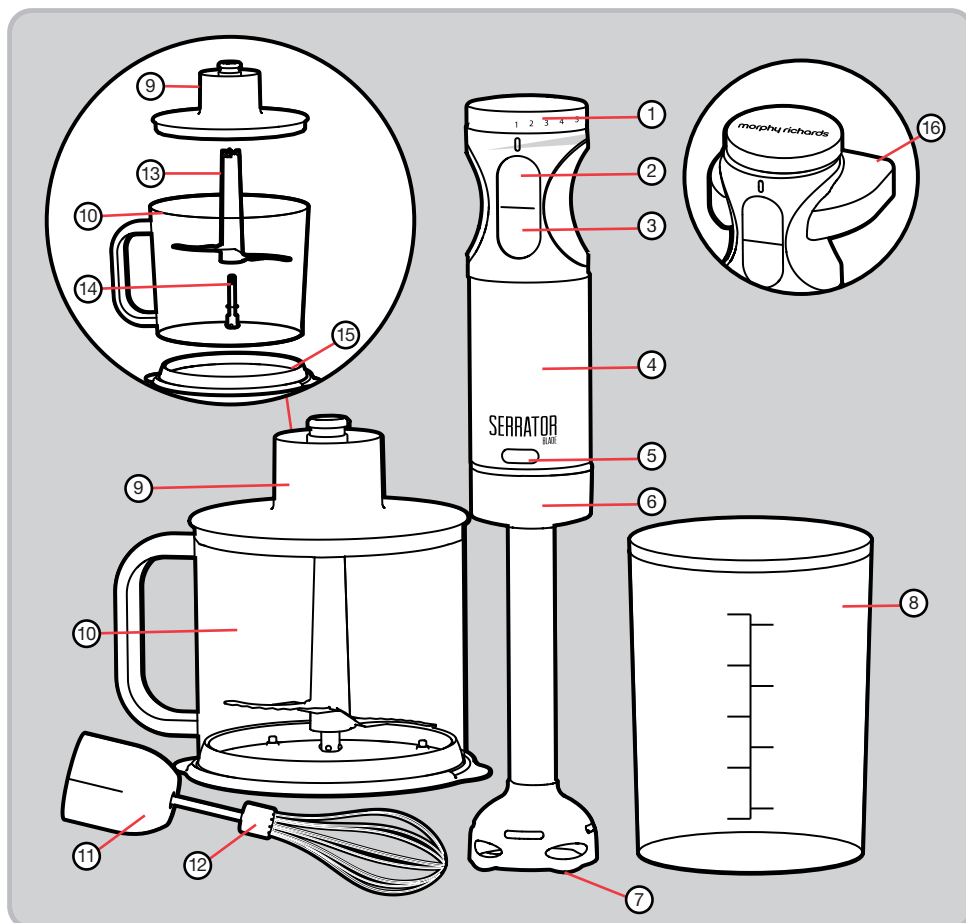

Features

- | | |
|-----------------------|---|
| (1) Speed Control | (10) Chopping Bowl |
| (2) On Button | (11) Whisk Gearbox |
| (3) Turbo Button | (12) Balloon Whisk |
| (4) Main Unit | (13) Chopping Serrator Blade |
| (5) Release Button | (14) Spindle |
| (6) Blending Leg | (15) Chopping Bowl Slip Mat / Lid Cover |
| (7) Serrator Blade | (16) Wall Bracket |
| (8) Measuring Beaker | |
| (9) Chopping Bowl Lid | |

Before first use

- **WARNING:** Carefully unpack your Accents Hand Blender as the blades are very sharp.
- Wash all parts before first use, except for the blender body, see the 'Cleaning' section on page 7 for instructions.

Using your Accents Hand Blender

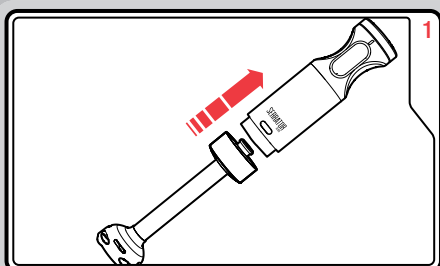

Insert the Blending Leg (6) into the Main Unit (4) and click into place.

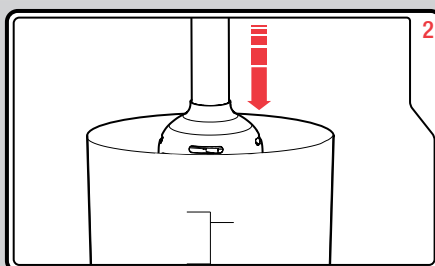

Place leg into food to be blended. **DO NOT** blend in the Chopping Bowl (10). Use the Measuring Beaker (8).

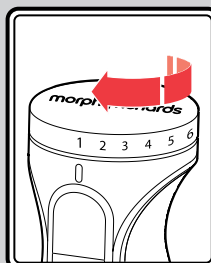

Select the speed on the Speed Control (1) and press and hold the On Button (2) to start. Release the button to stop **BEFORE** removing the Blending Leg from the food.

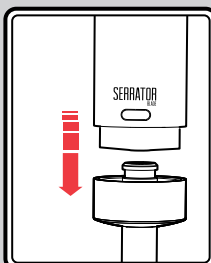
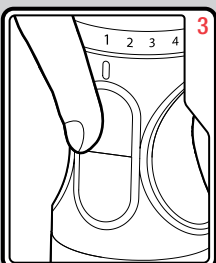

Press the Release Button (5) and gently pull the Blending Leg to remove. Rinse the Blending Leg in running water.

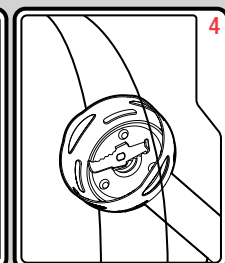

Usage

- **WARNING:** Your Accents Hand Blender is designed for intermittent use. Do not use non-stop for more than 1 minute. Allow to cool down for a minimum of 5 minutes before further use.
- 1 Place a maximum of 4 ice cubes in the Measuring Beaker (8).
- 2 Press firmly down on the ice cubes with the blender, using a plunging action until the ice cubes are fine ice pieces.
- **DO NOT** crush ice in the Chopping Bowl (10) as it will damage the blades.
- Note: The ice cubes need to be able to project into the blender head to be crushed by the Serrator Blade (7).

Crushing Ice

- The Blender Leg (6) is fitted with a special blade suitable for crushing ice. It can be used to crush ice cubes to produce fine ice for cocktails, cold drinks etc.

Using your Accents Hand Blender with Chopping Bowl

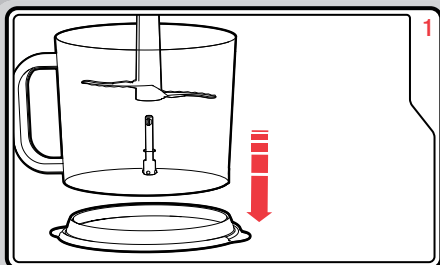

Fit the Chopping Bowl (10) onto the Base (16) and insert the Serrator Blade (13) onto the Spindle (14).

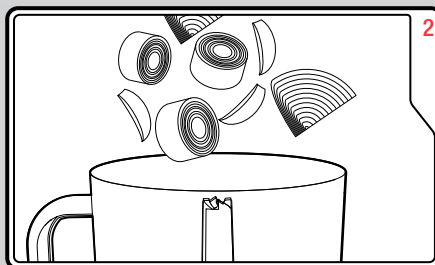

Add the food to the Chopping Bowl. Do not exceed the amounts listed on page 8.

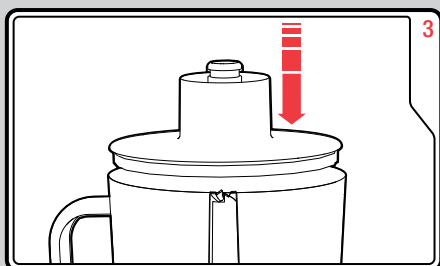

Place the Chopping Bowl Lid (9) onto the Chopping Bowl. Ensure it is placed correctly onto the Chopping Serrator Blade.

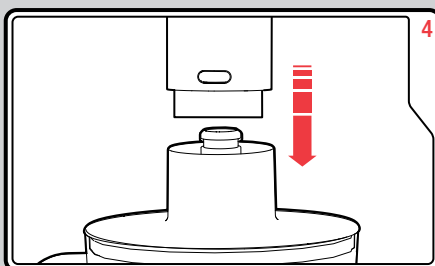

Place the Main Unit (4) onto the Chopping Bowl Lid until it clicks into place.

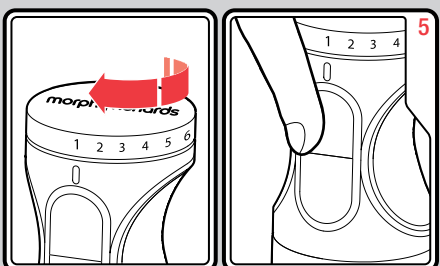

Select the speed on the Speed Control (1) and press and hold the On Button (2) to start. Hold the Chopping Bowl down firmly while in use.

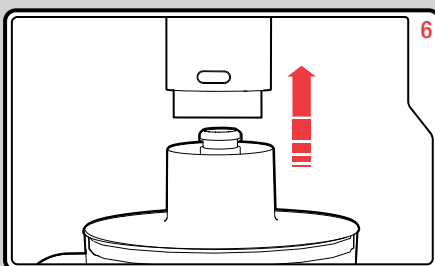

Press the Release Button (5) to remove the Main Unit from the Chopping Bowl.

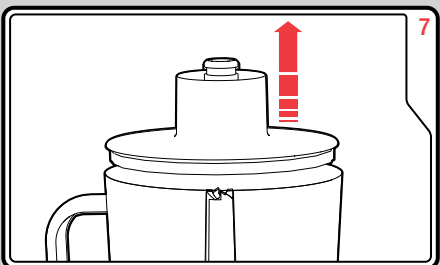

Remove the Chopping Bowl Lid.

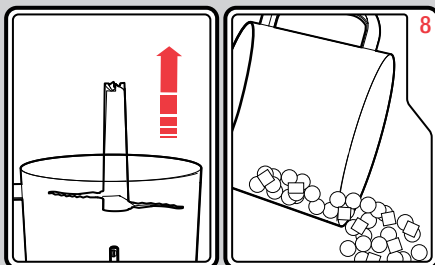

Remove the Chopping Serrator Blade from the bowl before removing food.

Turbo Button

- The Accents Hand Blender has 8 different speeds as well as a Turbo Button (3).

Press the Turbo Button to run the Accents Hand Blender on speed 8 for intermittent bursts.

Using the Balloon Whisk Attachment

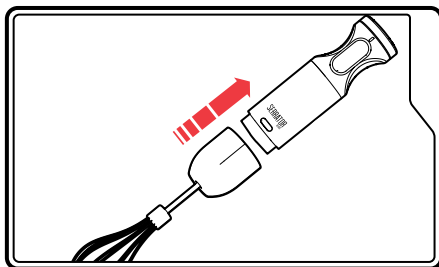

- 1 Insert the Balloon Whisk (12) into the Whisk Gearbox (11).
 - 2 Place the assembled Whisk onto the Main Unit (4), by aligning the release button indent on the Whisk Gearbox with the Main Unit push until it has clicked into place.
- To avoid splashing, start the whisking on speed 1 and increase to speed 3 if required.
Do not use the turbo setting.

Notes

- Your Accents Hand Blender is not suitable for grinding coffee beans.
- When chopping meat, ensure that all the bones have been removed before adding to the Chopping Bowl.

Top tips

- When blending foods with strong colour (eg. carrots), the plastic parts of the appliance may become discoloured. Wipe with cooking oil to clean any discoloured parts.
- For blending and chopping, select a slow speed for soft ingredients, increase the speed to produce the consistency required.
- Select a high speed for chopping or blending hard ingredients.

- When using the Blending Leg (6), start the process by plunging the blender into the ingredients. This will ensure all the ingredients are pulled into the blade to be processed. Continue this movement until the mixture is to the desired consistency.
- Do not lift the Blending Leg out of the mixture completely when running, as splashing may occur.
- The Chopping Bowl (10) is not suitable for grinding coffee beans.

Care and cleaning

- WARNING:** Always unplug the appliance from the mains socket before cleaning and maintenance.

WARNING: Handle the blades with care as they are sharp.

The Whisk Gearbox (11) and Chopping Bowl Lid (9) should be wiped over with a warm soapy cloth. Do not immerse these parts in water.

Clean the Main Unit (4) with a damp cloth and dry all the parts thoroughly.

WARNING: Never immerse the Main Unit in water or any other liquid.

Wall mounting

- The Accents Hand Blender can be wall mounted for convenient storage.

WARNING: Always ensure you are not drilling into the wall adjacent to any electrical wires or pipes, such as water or gas.

Do not mount the Wall Bracket (16) over or near any portion of a heating or cooking appliance or sink or basin.

- 1 Find a suitable position on the wall or cupboard where the Accents Hand Blender is to be positioned.
- 2 Mark the fixing points through the Wall Bracket.
- 3 If you are fixing to a solid brick or block wall, use a 6mm masonry drill and drill to a depth of 25mm.
- 4 If fixing to a wood or cupboard surface, drill a 2mm pilot hole or use a bradawl.

Chopping Bowl capacity

Guidelines are provided below. These may vary according to the quantity and the consistency of the food. Do not process for more than 1 minute at a time.

Food	Capacity	Preparation	Approx Time
• Beef	• 400g	• Dice approx 2cm	• 20-30 seconds
• Pork	• 400g	• Dice approx 2cm	• 20-30 seconds
• Hard cheese	• 250g	• Dice approx 1cm	• 30-40 seconds
• Almonds	• 300g	• None	• 10-20 seconds
• Hard boiled eggs	• 3	• Cut into halves	• 3-5 seconds
• Onion	• 250g	• Cut into quarters	• 3-6 seconds
• Parsley	• Large bunch	• Remove stalks	• 3-5 seconds
• Carrots	• 400g	• Slice	• 5-10 seconds
• Dry bread	• 2 slices	• Cut into quarters	• 10-20 seconds

Troubleshooting

Problem	Reason	Solution
• The Accents Hand Blender is not working.	• The hand blender is not switched on.	• Check the mains outlet and the mains outlet.
• The Accents Hand Blender is not working.	• The attachment is not correctly installed.	• Release the Attachment from the Main Unit and re-attach.
• The Accents Hand Blender is overheating.	• The hand blender has been used for too long continuously	• Allow to cool before using again.

Contact us

Helpline

If you are having a problem with your appliance, please call our Helpline, as we are more likely to be able to help than the store you purchased the item from.

Please have the product name, model number and serial number to hand when you call to help us deal with your enquiry quicker.

UK Helpline: 0344 871 0944

IRE Helpline: 1800 409 119

Spares: 0344 873 0710

Talk To Us

If you have any questions or comments, or want some great tips or recipe ideas to help you get the most out of your products, join us online:

Blog: www.morphyrichards.co.uk/blog

Facebook: www.facebook.com/morphyrichardsuk

Twitter: @loveyourmorphy

Website: www.morphyrichards.com

Notes

Notes

Notes

FP402010 MUK Rev 3 11/14

Lifetime blade guarantee

The 'Serrator Blade' is warranted to be free from defects in materials and workmanship for life. This warranty covers the original purchaser only and is not assignable or transferable to any other party. This warranty is available to consumers who use the 'Serrator Blades' for non-commercial household purposes. This warranty does not cover any damage caused by accident, misuse or any use other than as described in your owner's manual, or damage resulting from failure to maintain and clean this product as specified in your owner's manual.

Registering your 5 year guarantee

Your standard two year product guarantee is extended for an additional 36 months when you register the product within 28 days of purchase with Morphy Richards. If you do not register the product with Morphy Richards within 28 days, your product is guaranteed for 2 years. To validate your 5 year guarantee register with us online at www.morphyrichards.co.uk

Or call our customer registration line

UK 0344 871 0944

IRE 1800 409 119

N.B. Each qualifying product needs to be registered with Morphy Richards individually.

Please note that the 5 year guarantee is only available in the UK and Ireland. Please refer to the 2 year guarantee for more information.

Your 2 year guarantee

It is important to retain the retailer's receipt as proof of purchase. Staple your receipt to this back cover for future reference.

Please quote the following information if the product develops a fault. These numbers can be found on the base of the product.

Model no.

Serial no.

All Morphy Richards products are individually tested before leaving the factory. In the unlikely event of any appliance proving to be faulty within 28 days of purchase, it should be returned to the place of purchase for it to be replaced.

If the fault develops after 28 days and within 24 months of original purchase, you should contact the Helpline number quoting Model number and Serial number on the product, or write to Morphy Richards at the address shown.

You may be asked to return a copy of proof of purchase.

Subject to the exclusions set out below (see Exclusions), the faulty appliance will then be repaired or replaced as appropriate and dispatched usually within 7 working days of receipt.

If, for any reason, this item is replaced or repaired during the 2 year guarantee period, the guarantee on the new item will be calculated from original purchase date.

Therefore it is vital to retain your original till receipt or invoice to indicate the date of initial purchase.

To qualify for the 2 year guarantee, the appliance must have been used according to the instructions supplied. For example, crumb trays should have been emptied regularly.

Exclusions

Morphy Richards shall not be liable to replace or repair the goods under the terms of either the Lifetime Blade Guarantee or the 2 or 5 Year Guarantee where:

- 1 The fault has been caused or is attributable to accidental use, misuse, negligent use or used contrary to the manufacturer's recommendations or where the fault has been caused by power surges or damage caused in transit.
 - 2 The appliance has been used on a voltage supply other than that stamped on the products.
 - 3 Repairs have been attempted by persons other than our service staff (or authorised dealer).
 - 4 The appliance has been used for hire purposes or non domestic use.
 - 5 The appliance is second hand.
 - 6 Morphy Richards reserves the right not to carry out any type of servicing under the guarantee at its discretion
 - 7 Plastic filters for all Morphy Richards kettles and coffee makers are not covered by the guarantee.
 - 8 Batteries and damage from leakage are not covered by the guarantee.
- These guarantees does not confer any rights other than those expressly set out above and do not cover any claims for consequential loss or damage. These guarantees are offered as an additional benefit and do not affect your statutory rights as a consumer. Morphy Richards products are intended for household use only. See usage limitations within the location safety instructions.

Disclaimer

Morphy Richards has a policy of continuous improvement in product quality and design. The company, therefore reserves the right to change the specification of it's models at any time.



For electrical products sold within the European Community. At the end of the electrical products useful life, it should not be disposed of with household waste.

Please recycle where facilities exist. Check with your Local Authority or retailer for recycling advice in your country

**IF YOU ARE HAVING A PROBLEM
WITH ONE OF OUR PRODUCTS, CALL
OUR HELPLINE:**

**UK: 0344 871 0944
EIRE: 1800 409 119
SPARES: 0344 873 0710**

morphy richards

The After Sales Division
Morphy Richards Ltd
Mexborough, South Yorkshire,
England, S64 8AJ

Helplines (office hours)
UK 0344 871 0944
Spare Parts 0344 873 0710
Republic of Ireland 1800 409 119
www.morphyrichards.com

